



Project Number 3113

Management  
Asbestos Survey Report

Kennet Centre, Market Street, Newbury,  
Berkshire, RG14 5EN

139 Bartholomew Street



*Working in Partnership with Shield Environmental Services*



Document Name	Author	Issued by	Revision Number	Issue Date	Page No
2019	Kacey Lillis	Armour AS	0	29/11/2019	1



## Contents

Section	
1	Contacts & Authorisation
2	Executive Summary
3	Site Description & Survey Information
4	Positive and Presumed Photos Sheets
5	Negative Photos Sheets
6	Survey Objectives
7	Survey Techniques
8	Survey Caveat
9	Survey Notes
10	Material Assessment Algorithm
11	Certificates of Bulk Analysis
12	Site Plan

Document Name	Author	Issued by	Revision Number	Issue Date	Page No
2019	Kacey Lillis	Armour AS	0	29/11/2019	2



## Section 1: Contact Details

Client Details:		Instructing Party:	
Lochailort Newbury Ltd Eagle House 108-110 Jermyn Street London SW1Y 6EE		Lochailort Newbury Ltd Eagle House 108-110 Jermyn Street London SW1Y 6EE	
Contact Name:	James Croucher	Contact Name:	James Croucher
Tel: 07590397181	Fax: N/A	Tel: 07590397181	Fax: N/A

Site Address:		Report Author:	
Kennet Centre Market Street Newbury Berkshire RG14 5EN		Armour Analytical Services Admirals Yard Station Road Bristol BS34 6LR	
Contact Name:	Richard Farley	Contact Name:	Emma Humphreys
Tel: 0163540748	Fax: N/A	Mobile: 07468535836	

Lead Surveyor's Name:	Lead Surveyor's Authorising Signature:
N. Evans	

Document Name	Author	Issued by	Revision Number	Issue Date	Page No
2019	Kacey Lillis	Armour AS	0	29/11/2019	3



## Section 2: Executive Summary

Sample Number	Sample Type	Location	Analysis
NE/1	Vinyl Floor Tiles	First Floor – 006 Corridor	N.A.D.I.S
NE/2	Vinyl Floor Tiles	First Floor – 011 Canteen	N.A.D.I.S

N.A.D.I.S – No Asbestos Detected in Sample

Document Name	Author	Issued by	Revision Number	Issue Date	Page No
2019	Kacey Lillis	Armour AS	0	29/11/2019	4



## Section 3: Site Description & Survey Information

### Brief description on the general building construction

Part of A Large Shopping Centre, Pitched Metal Roof, Brick/Block.

### Caveat for no access areas

N/A

### EXTERNAL MATERIALS

Roof Type	Metal, Pitched
Roof Materials	Metal
Soffits	N/A
Fascia	Metal
Walls	Brick
Verge Under cloaking	N/A
Guttering	Plastic
Downpipes	Metal
Window/Door frames	Metal, Wood
Other Materials	N/A

### INTERNAL MATERIALS

Loft Insulation	N/A
Roof Underlining	Metal
Ceilings	Metal
Walls <i>Internal</i>	Brick/Block, Plasterboard, Wood
Floors	Concrete
Doors/Frames	Wood, Metal
Pipework/Insulation	Metal
Boxings	Wood, Plasterboard
Boiler Make	Ariston
Flue Pipes	Metal
Storage Heaters	N/A
Electrical Boxes/Machinery	Live
Ducting/Risers	N/A
Stairs	Concrete, Wood
Lift Shafts	Metal, Plastic-lined
Other Materials	Rubber Step Nosing, New Sink Pad

Document Name	Author	Issued by	Revision Number	Issue Date	Page No
2019	Kacey Lillis	Armour AS	0	29/11/2019	5

## Section 4: Positive and Presumed Photos Sheets

No positive or presumed items were found during this survey

Document Name	Author	Issued by	Revision Number	Issue Date	Page No
2019	Kacey Lillis	Armour AS	0	29/11/2019	6



Section 5: Negative Photos Sheets

Item No: 1	Sample No: N/A
Location: 1/001 Shop Floor	



Material Description:	Visual Inspection – No Suspect Materials Found	
Identification:	N/A	
Approx. quantity:	N/A	
Accessibility	N/A	Assessment Score
Product type:	N/A	N/A
Extent of Damage:	N/A	N/A
Surface Treatment:	N/A	N/A
Asbestos type:	N/A	N/A
Material Assessment Score:		N/A
Priority Assessment Score:		N/A
Action:	N/A	
Comments:	N/A	

Document Name	Author	Issued by	Revision Number	Issue Date	Page No
2019	Kacey Lillis	Armour AS	0	29/11/2019	7



Item No: 2

Sample No: N/A

Location: 1/001A Electrics Cupboard



Material Description:	Visual Inspection – No Suspect Materials Found	
Identification:	N/A	
Approx. quantity:	N/A	
Accessibility	N/A	Assessment Score
Product type:	N/A	N/A
Extent of Damage:	N/A	N/A
Surface Treatment:	N/A	N/A
Asbestos type:	N/A	N/A
Material Assessment Score:		N/A
Priority Assessment Score:		N/A
Action:	N/A	
Comments:	N/A	

Document Name	Author	Issued by	Revision Number	Issue Date	Page No
2019	Kacey Lillis	Armour AS	0	29/11/2019	8





Item No: 3

Sample No: N/A

Location: 1/002 Shop Floor



Material Description:	Visual Inspection – No Suspect Materials Found	
Identification:	N/A	
Approx. quantity:	N/A	
Accessibility	N/A	Assessment Score
Product type:	N/A	N/A
Extent of Damage:	N/A	N/A
Surface Treatment:	N/A	N/A
Asbestos type:	N/A	N/A
Material Assessment Score:		N/A
Priority Assessment Score:		N/A
Action:	N/A	
Comments:	N/A	

Document Name	Author	Issued by	Revision Number	Issue Date	Page No
2019	Kacey Lillis	Armour AS	0	29/11/2019	9



Item No: 4

Sample No: N/A

Location: 1/003 Shop Floor



Material Description:	Visual Inspection – No Suspect Materials Found	
Identification:	N/A	
Approx. quantity:	N/A	
Accessibility	N/A	Assessment Score
Product type:	N/A	N/A
Extent of Damage:	N/A	N/A
Surface Treatment:	N/A	N/A
Asbestos type:	N/A	N/A
Material Assessment Score:		N/A
Priority Assessment Score:		N/A
Action:	N/A	
Comments:	N/A	

Document Name	Author	Issued by	Revision Number	Issue Date	Page No
2019	Kacey Lillis	Armour AS	0	29/11/2019	10



Item No: 5

Sample No: N/A

Location: 1/004 Lift



Material Description:	Visual Inspection – No Suspect Materials Found	
Identification:	N/A	
Approx. quantity:	N/A	
Accessibility	N/A	<i>Assessment Score</i>
Product type:	N/A	N/A
Extent of Damage:	N/A	N/A
Surface Treatment:	N/A	N/A
Asbestos type:	N/A	N/A
Material Assessment Score:		N/A
Priority Assessment Score:		N/A
Action:	N/A	
Comments:	N/A	

Document Name	Author	Issued by	Revision Number	Issue Date	Page No
2019	Kacey Lillis	Armour AS	0	29/11/2019	11



Item No: 6

Sample No: N/A

Location: 1/005 Stairs

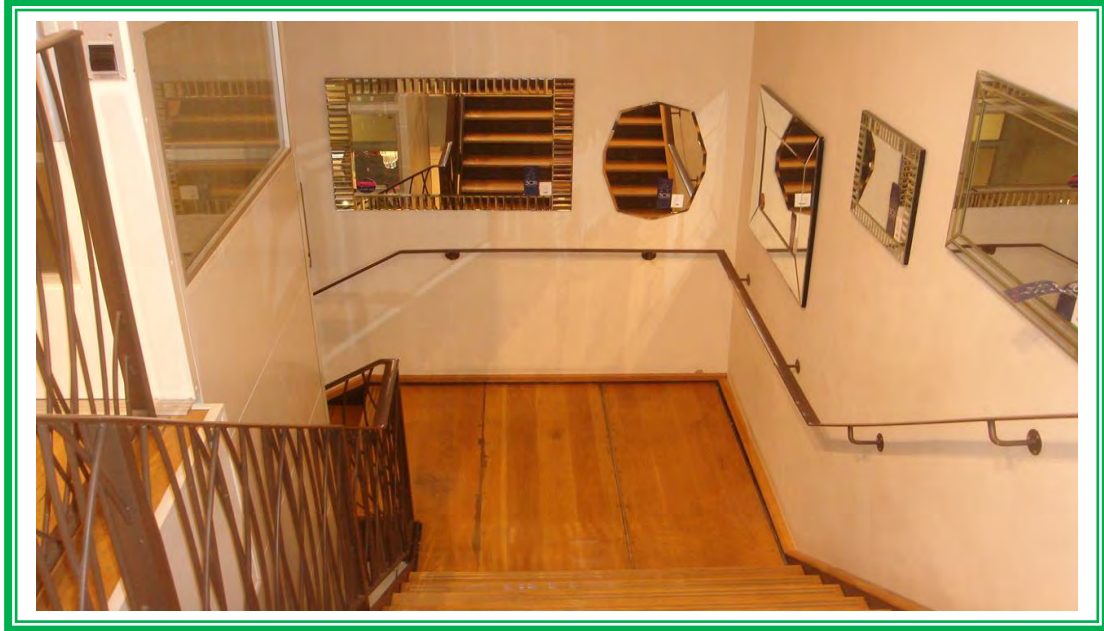

Material Description:	Visual Inspection – No Suspect Materials Found	
Identification:	N/A	
Approx. quantity:	N/A	
Accessibility	N/A	Assessment Score
Product type:	N/A	N/A
Extent of Damage:	N/A	N/A
Surface Treatment:	N/A	N/A
Asbestos type:	N/A	N/A
Material Assessment Score:		N/A
Priority Assessment Score:		N/A
Action:	N/A	
Comments:	N/A	

Document Name	Author	Issued by	Revision Number	Issue Date	Page No
2019	Kacey Lillis	Armour AS	0	29/11/2019	12



Item No: 7

Sample No: NE/1

Location: 1/006 Corridor



Material Description:	Vinyl Floor Tiles	
Identification:	Sampled - No Asbestos Detected	
Approx. quantity:	6M2	
Accessibility	N/A	Assessment Score
Product type:	N/A	N/A
Extent of Damage:	N/A	N/A
Surface Treatment:	N/A	N/A
Asbestos type:	N/A	N/A
Material Assessment Score:		N/A
Priority Assessment Score:		N/A
Action:	N/A	
Comments:	N/A	

Document Name	Author	Issued by	Revision Number	Issue Date	Page No
2019	Kacey Lillis	Armour AS	0	29/11/2019	13



Item No: 8

Sample No: N/A

Location: 1/007 Corridor



Material Description:	Vinyl Floor Tiles	
Identification:	As Per Sample NE/1 – No Asbestos Detected	
Approx. quantity:	40M2	
Accessibility	N/A	Assessment Score
Product type:	N/A	N/A
Extent of Damage:	N/A	N/A
Surface Treatment:	N/A	N/A
Asbestos type:	N/A	N/A
Material Assessment Score:		N/A
Priority Assessment Score:		N/A
Action:	N/A	
Comments:	N/A	

Document Name	Author	Issued by	Revision Number	Issue Date	Page No
2019	Kacey Lillis	Armour AS	0	29/11/2019	14



Item No: 9

Sample No: N/A

Location: 1/008 Store



Material Description:	Vinyl Floor Tiles	
Identification:	As Per Sample NE/1 – No Asbestos Detected	
Approx. quantity:	30M2	
Accessibility	N/A	Assessment Score
Product type:	N/A	N/A
Extent of Damage:	N/A	N/A
Surface Treatment:	N/A	N/A
Asbestos type:	N/A	N/A
Material Assessment Score:		N/A
Priority Assessment Score:		N/A
Action:	N/A	
Comments:	N/A	

Document Name	Author	Issued by	Revision Number	Issue Date	Page No
2019	Kacey Lillis	Armour AS	0	29/11/2019	15



Item No: 10

Sample No: N/A

Location: 1/009 Office



Material Description:	Visual Inspection – No Suspect Materials Found	
Identification:	N/A	
Approx. quantity:	N/A	
Accessibility	N/A	Assessment Score
Product type:	N/A	N/A
Extent of Damage:	N/A	N/A
Surface Treatment:	N/A	N/A
Asbestos type:	N/A	N/A
Material Assessment Score:		N/A
Priority Assessment Score:		N/A
Action:	N/A	
Comments:	N/A	

Document Name	Author	Issued by	Revision Number	Issue Date	Page No
2019	Kacey Lillis	Armour AS	0	29/11/2019	16





Item No: 11

Sample No: N/A

Location: 1/010 Store



Material Description:	Visual Inspection – No Suspect Materials Found	
Identification:	N/A	
Approx. quantity:	N/A	
Accessibility	N/A	Assessment Score
Product type:	N/A	N/A
Extent of Damage:	N/A	N/A
Surface Treatment:	N/A	N/A
Asbestos type:	N/A	N/A
Material Assessment Score:		N/A
Priority Assessment Score:		N/A
Action:	N/A	
Comments:	N/A	

Document Name	Author	Issued by	Revision Number	Issue Date	Page No
2019	Kacey Lillis	Armour AS	0	29/11/2019	17



Item No: 12

Sample No: NE/2

Location: 1/011 Canteen



Material Description:	Vinyl Floor Tiles	
Identification:	Sampled - No Asbestos Detected	
Approx. quantity:	16M2	
Accessibility	N/A	Assessment Score
Product type:	N/A	N/A
Extent of Damage:	N/A	N/A
Surface Treatment:	N/A	N/A
Asbestos type:	N/A	N/A
Material Assessment Score:		N/A
Priority Assessment Score:		N/A
Action:	N/A	
Comments:	N/A	

Document Name	Author	Issued by	Revision Number	Issue Date	Page No
2019	Kacey Lillis	Armour AS	0	29/11/2019	18



Item No: 13

Sample No: N/A

Location: 1/012 WC



Material Description:	Vinyl Floor Tiles	
Identification:	As Per Sample NE/2 – No Asbestos Detected	
Approx. quantity:	3M2	
Accessibility	N/A	Assessment Score
Product type:	N/A	N/A
Extent of Damage:	N/A	N/A
Surface Treatment:	N/A	N/A
Asbestos type:	N/A	N/A
Material Assessment Score:		N/A
Priority Assessment Score:		N/A
Action:	N/A	
Comments:	N/A	

Document Name	Author	Issued by	Revision Number	Issue Date	Page No
2019	Kacey Lillis	Armour AS	0	29/11/2019	19



Item No: 14

Sample No: N/A

Location: 1/013 WC



Material Description:	Vinyl Floor Tiles	
Identification:	As Per Sample NE/2 – No Asbestos Detected	
Approx. quantity:	3M2	
Accessibility	N/A	Assessment Score
Product type:	N/A	N/A
Extent of Damage:	N/A	N/A
Surface Treatment:	N/A	N/A
Asbestos type:	N/A	N/A
Material Assessment Score:		N/A
Priority Assessment Score:		N/A
Action:	N/A	
Comments:	N/A	

Document Name	Author	Issued by	Revision Number	Issue Date	Page No
2019	Kacey Lillis	Armour AS	0	29/11/2019	20



Item No: 15

Sample No: N/A

Location: 1/014 Stairs



Material Description:	Vinyl Floor Tiles	
Identification:	As Per Sample NE/2 – No Asbestos Detected	
Approx. quantity:	20M2	
Accessibility	N/A	Assessment Score
Product type:	N/A	N/A
Extent of Damage:	N/A	N/A
Surface Treatment:	N/A	N/A
Asbestos type:	N/A	N/A
Material Assessment Score:		N/A
Priority Assessment Score:		N/A
Action:	N/A	
Comments:	N/A	

Document Name	Author	Issued by	Revision Number	Issue Date	Page No
2019	Kacey Lillis	Armour AS	0	29/11/2019	21



Item No: 16

Sample No: N/A

Location: 0/001 Shop Floor



Material Description:	Visual Inspection – No Suspect Materials Found	
Identification:	N/A	
Approx. quantity:	N/A	
Accessibility	N/A	Assessment Score
Product type:	N/A	N/A
Extent of Damage:	N/A	N/A
Surface Treatment:	N/A	N/A
Asbestos type:	N/A	N/A
Material Assessment Score:		N/A
Priority Assessment Score:		N/A
Action:	N/A	
Comments:	N/A	

Document Name	Author	Issued by	Revision Number	Issue Date	Page No
2019	Kacey Lillis	Armour AS	0	29/11/2019	22



Item No: 17

Sample No: N/A

Location: 0/002 Cupboard



Material Description:	Visual Inspection – No Suspect Materials Found	
Identification:	N/A	
Approx. quantity:	N/A	
Accessibility	N/A	Assessment Score
Product type:	N/A	N/A
Extent of Damage:	N/A	N/A
Surface Treatment:	N/A	N/A
Asbestos type:	N/A	N/A
Material Assessment Score:		N/A
Priority Assessment Score:		N/A
Action:	N/A	
Comments:	N/A	

Document Name	Author	Issued by	Revision Number	Issue Date	Page No
2019	Kacey Lillis	Armour AS	0	29/11/2019	23



Item No: 18

Sample No: N/A

Location: 99/001 External



Material Description:	Visual Inspection – No Suspect Materials Found	
Identification:	N/A	
Approx. quantity:	N/A	
Accessibility	N/A	Assessment Score
Product type:	N/A	N/A
Extent of Damage:	N/A	N/A
Surface Treatment:	N/A	N/A
Asbestos type:	N/A	N/A
Material Assessment Score:		N/A
Priority Assessment Score:		N/A
Action:	N/A	
Comments:	N/A	

Document Name	Author	Issued by	Revision Number	Issue Date	Page No
2019	Kacey Lillis	Armour AS	0	29/11/2019	24





## Section 6: Survey Objectives

Instructions were received from James Croucher of Lochailort Newbury Ltd to carry out a Management asbestos survey at Kennet Centre, Market Street, Newbury, Berkshire, RG14 5EN in accordance with HSG264 and Armour Analytical's quality procedures.

The survey was carried out on 4<sup>th</sup> – 8<sup>th</sup> November 2019 by Neale Evans with the objective of facilitating a Management report.

This Management survey is characterised as a 'Visual Inspection Sampling and Identification Survey' in HSG264. This type of survey is used to locate and describe, so far as is reasonably practicable, all asbestos containing materials (ACMs) in the building and will by its nature involve the partial destruction of the building's fabric as access is gained to all areas. A full sampling programme is undertaken to identify possible ACMs and estimate the extent of ACMs reported.

The objective of this survey report is to identify, so far as is reasonably practicable, the location, extent, product type and composition of ACMS within the building to enable the building occupants to put management and remedial procedures in place.

Document Name	Author	Issued by	Revision Number	Issue Date	Page No
2019	Kacey Lillis	Armour AS	0	29/11/2019	25



## Section 7: Survey Techniques

Each floor, room and area within the scope was systematically inspected for suspect materials thought or known to contain asbestos and where such materials were encountered their location, extent, and composition were recorded.

Where materials of a similar nature exist, to those previously sampled, and a reasoned argument can be made that their composition is likely to be identical further physical sampling was not undertaken.

Photographs were taken of all sample locations, unless otherwise stated.

The analysis of suspect ACMs was undertaken by a UKAS accredited laboratory using the analytical method detailed in *HSG248, Appendix 2 -Asbestos: The analysts' guide for sampling, analysis and clearance procedures*.

Document Name	Author	Issued by	Revision Number	Issue Date	Page No
2019	Kacey Lillis	Armour AS	0	29/11/2019	26

## Section 8: Survey Caveat

This report is based upon a management report inspection of an unfamiliar site. During the course of the survey all reasonable efforts were made to identify the physical presence of materials containing asbestos within the building.

A Management Survey is a non-intrusive survey, meaning that access within the fabric of the building is limited. The survey does not include access to the following areas (unless agreed beforehand with the Client and provisions are put in place):

- Within wall or ceiling construction;
- Under fixed flooring;
- Within non-openable boxings;
- Within live electrics, boilers or machinery;
- Where access/visibility is limited in an area due to stored items, furniture or services;
- Areas where there is no safe access to inspect such as floor ducts, lift shafts and loft spaces with no crawlboards;
- High level areas that are too high to safely inspect.
- Within pipework insulation throughout building as this would affect the integrity of services.

Any intrusive works carried out within the building must first be subject to a Refurbishment Asbestos Survey.

This report will be restricted to the areas that fall within the scope of works for project and will **not take into account any area's that do not fall within the scope. Any asbestos that is identified** within this report will need to be added to the buildings existing information and should not form the basis for a management survey. This survey will not include priority assessments nor will it include a register.

This survey considered the construction of the building, associated fixtures & fittings and associated structures and in no way should it be considered as a ground investigation report.

Services should be disconnected prior to commencement of a Management survey; however, where plant and/or electrical installations are live or appear to be live then these will not be accessed.

This survey report is not a bill of quantities.

Document Name	Author	Issued by	Revision Number	Issue Date	Page No
2019	Kacey Lillis	Armour AS	0	29/11/2019	27

## Section 9: Survey Notes

This report has been written with reference to the various Guidance Notes etc, issued, and current at the date of this report and describes circumstances at the site on the date the investigation took place.

Where similar items exist in the building, only one or two samples have been taken to ascertain the material content. It was assumed that similar products were of the same material.

Any person undertaking work within the buildings should be told of the presence of asbestos. This briefing also applies to any other person associated with the site, including staff, sub-contractors and others.

The drawings in the report are not to scale and are illustrative only to indicate approximate locations. The descriptions used are for location identification purposes.

All the recommendations described in this report are based upon assumptions made after consideration of the type of material, condition of the material, its location, analysis result and type of use the area is thought to be subjected to. However, statutory authorities or others could require amendments based on local knowledge, change in legislation, change in use or indeed other conditions or criteria.

Samples taken from floor tiles (or similar material) may include a bitumen adhesive as part of the sample. It is known that some proprietary brands of bitumen have an asbestos content and this will be included as an integral part of the bulk sample unless otherwise stated.

Document Name	Author	Issued by	Revision Number	Issue Date	Page No
2019	Kacey Lillis	Armour AS	0	29/11/2019	28

## Section 10: Material Assessment Algorithm

Variable	Score	Examples
Installation / Product type	1	<b>Vinyl, 'Bakelite', Cement</b>
	2	Asbestos insulating board, paper, rope
	3	Pipe insulation, spray coating, friable debris
Condition / damage	0	Good
	1	Slight / minor damage
	2	Moderate damage – breakage to surface treatment
	3	Major damage – smashed or exposed material
Surface treatment	0	Non-friable e.g. vinyl
	1	Enclosed insulation, encapsulated AIB
	2	Unsealed AIB, encapsulated insulation
	3	Unsealed insulation or spray coating
Asbestos type	1	Chrysotile
	2	Amosite & other amphiboles
	3	Crocidolite

The scores from each of the four sections are added together to produce a risk score:

Risk score	Risk assessment
10 or more	High risk
7 – 9	Medium risk
5 – 6	Low risk
4 & below	Negligible risk

Document Name	Author	Issued by	Revision Number	Issue Date	Page No
2019	Kacey Lillis	Armour AS	0	29/11/2019	29



## Section 11: Certificates of Bulk Analysis



Our Ref: J179495 FI: 2  
Your Ref: 3113  
Date: 13/11/2019

**ENVIROCHEM**  
Analytical Laboratories Ltd.  
12 The Gardens  
Broadcut, Fareham  
Hampshire  
PO16 8SS



Tel: (01329) 287777  
Fax: (01329) 287755  
www.envirochem.co.uk  
office@envirochem.co.uk

### Asbestos Fibre Identification Report

**Client:** Armour Analytical Services Ltd  
Admirals Yard, Station Road, Patchway, Bristol, BS34 6LR

**Site Address:** Kennet Centre Market Place, 139 Bartholomsw Street, Newbury, RG14 5EN

**Sampled By:** Armour Analytical Services Ltd

**Date sampled/received:** 13th November 2019

**Date analysed:** 13th November 2019

**Analyst/s:** Ewelina Kowalczyk Pariyar

**Analysis Location:** 12 The Gardens, Broadcut, Fareham, Hampshire, PO16 8SS

#### ANALYTICAL PROCEDURE

Fibre identification was carried out in accordance with the documented 'in-house' method (2.01) based on the HSE Guidance Note HSG 248. These employed stereo microscopy, polarized microscopy and dispersion staining techniques.

#### RESULTS

Sample No.	Sample Ref.	Location	Asbestos Detected	Asbestos Type
NE/1	BS586088	1st Floor, 006 Corridor - Vinyl Floor Tiles	No	
NE/2	BS586089	1st Floor, 011 Canteen - Vinyl Floor Tiles	No	

#### NOTES:

1. Sample(s) were examined for the presence of 6 types of asbestos fibre: crocidolite (blue), amosite (brown), chrysotile (white), anthophyllite, actinolite and tremolite.
2. The results shown in this test report specifically refer to the sample(s) tested as received unless otherwise stated and samples collected by the client are evaluated using information provided by the client. For samples collected by the client the date of receipt is deemed to be the same as the date sampled.
3. Envirochem is a UKAS accredited laboratory for sampling and identification of asbestos containing materials.
4. Comments, observations and opinions are outside the scope of UKAS accreditation.
5. The analytical method in the ISO12468 does not quantify the amount of asbestos present, therefore UKAS accreditation does not permit quantification.
6. If, during fibre identification, only 1 or 2 fibres are seen and identified as asbestos, then the term 'trace asbestos identified' is used.
7. This report shall not be reproduced except in full, without written approval of Envirochem.

SIGNATURE: *Kowalczyk*

Authorised signatory

PRINT NAME: Ewelina Kowalczyk Pariyar





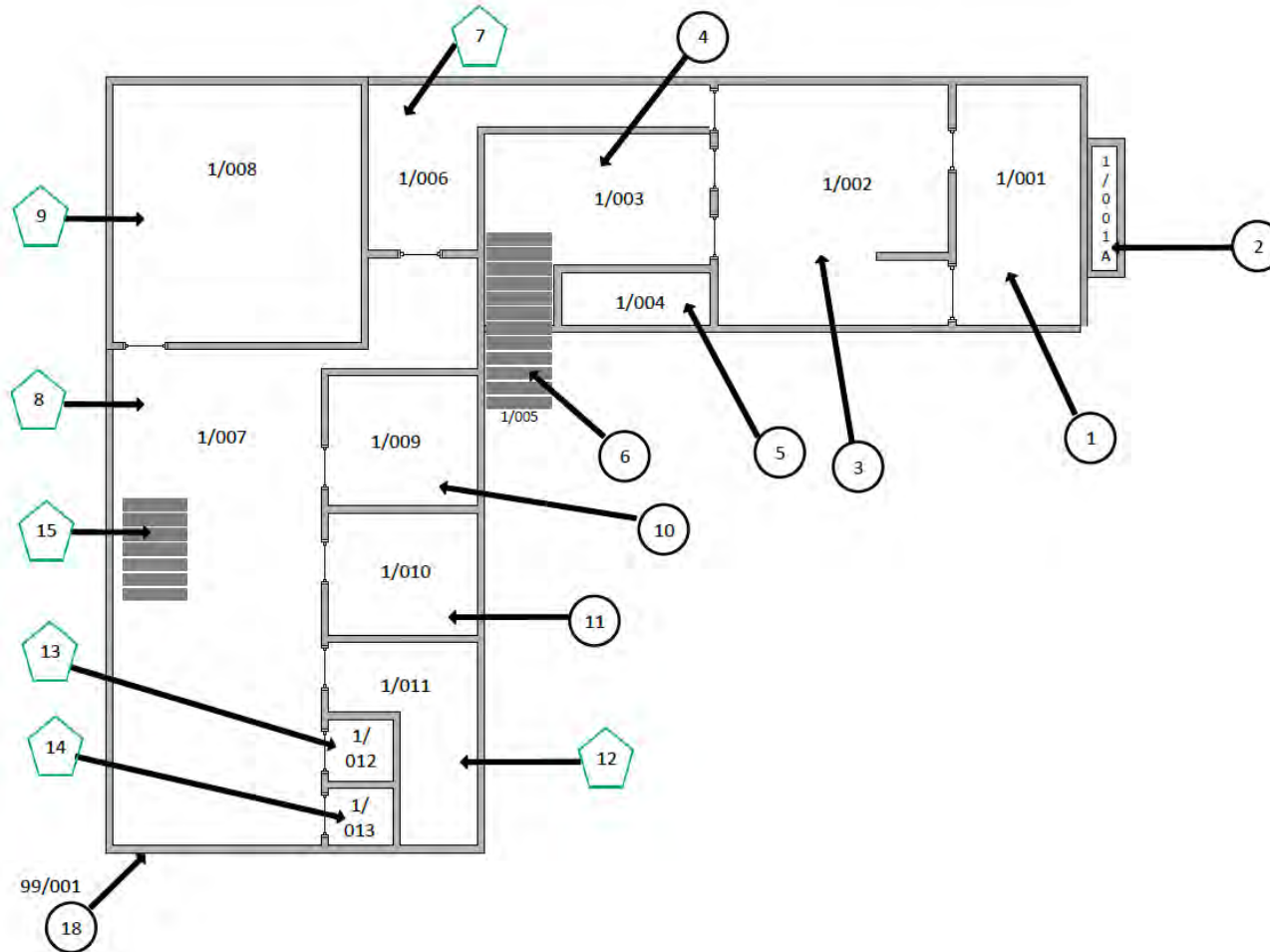

Reg. No. 2378228 England. Registered Office: Envirochem, 12 The Gardens, Broadcut, Fareham, Hampshire, PO16 8SS.

Page 1 of 1

Document Name	Author	Issued by	Revision Number	Issue Date	Page No
2019	Kacey Lillis	Armour AS	0	29/11/2019	30







## Section 12: Site Plan

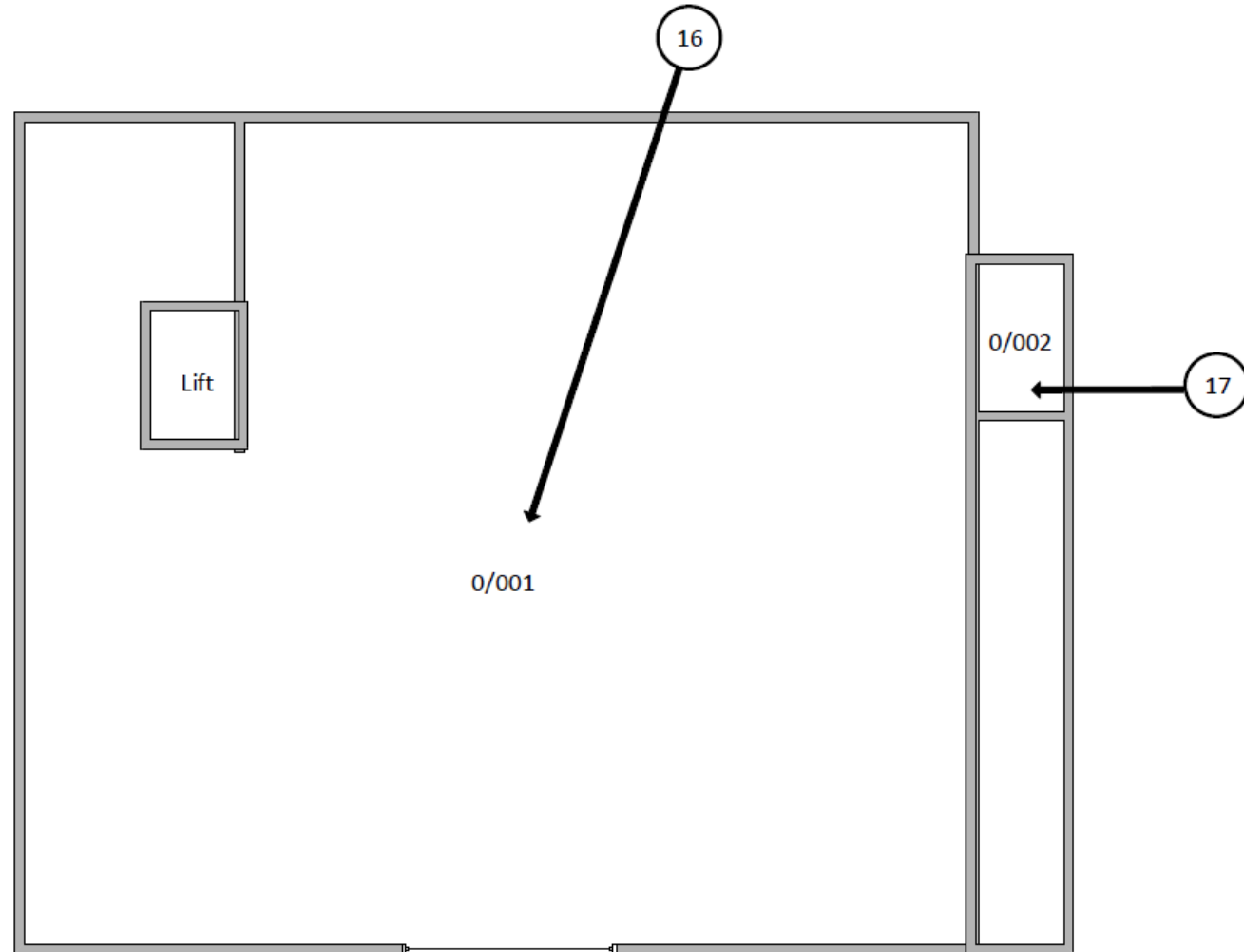

Key	
	Visual Inspection
	Asbestos Detected (Positive Item)
	No Asbestos Detected (Negative Item)
	Presumed to Contain Asbestos
	Strongly Presumed to Contain Asbestos
	No Access

Document Name	Author	Issued by	Revision Number	Issue Date	Page No
2019	Kacey Lillis	Armour AS	0	29/11/2019	31



Key	
	Visual Inspection
	Asbestos Detected (Positive Item)
	No Asbestos Detected (Negative Item)
	Presumed to Contain Asbestos
	Strongly Presumed to Contain Asbestos
	No Access

Document Name	Author	Issued by	Revision Number	Issue Date	Page No
2019	Kacey Lillis	Armour AS	0	29/11/2019	32





I the surveyor can confirm that this report is accurate to my findings onsite and this survey has been Content checked by myself.

Checked by: Neale Evans

Date: 28.11.2019

I the Admin Manager can confirm that this report is accurate to the paperwork received and this survey has been quality checked by myself.

Checked by: Emma Humphreys

Date: 27.11.2019

Report Compiled By

Armour Analytical Services Ltd, Admirals Yard, Station Road, Bristol, BS34 6LR

Document Name	Author	Issued by	Revision Number	Issue Date	Page No
2019	Kacey Lillis	Armour AS	0	29/11/2019	33



Project Number 3113

Management  
Asbestos Survey Report

Kennet Centre, Market Street, Newbury,  
Berkshire, RG14 5EN

141 Bartholomew Street



*Working in Partnership with Shield Environmental Services*



Document Name	Author	Issued by	Revision Number	Issue Date	Page No
2019	Kacey Lillis	Armour AS	0	29/11/2019	1



## Contents

Section	
1	Contacts & Authorisation
2	Executive Summary
3	Site Description & Survey Information
4	Positive and Presumed Photos Sheets
5	Negative Photos Sheets
6	Survey Objectives
7	Survey Techniques
8	Survey Caveat
9	Survey Notes
10	Material Assessment Algorithm
11	Certificates of Bulk Analysis
12	Site Plan

Document Name	Author	Issued by	Revision Number	Issue Date	Page No
2019	Kacey Lillis	Armour AS	0	29/11/2019	2



## Section 1: Contact Details

Client Details:		Instructing Party:	
Lochailort Newbury Ltd Eagle House 108-110 Jermyn Street London SW1Y 6EE		Lochailort Newbury Ltd Eagle House 108-110 Jermyn Street London SW1Y 6EE	
Contact Name:	James Croucher	Contact Name:	James Croucher
Tel: 07590397181	Fax: N/A	Tel: 07590397181	Fax: N/A

Site Address:		Report Author:	
Kennet Centre Market Street Newbury Berkshire RG14 5EN		Armour Analytical Services Admirals Yard Station Road Bristol BS34 6LR	
Contact Name:	Richard Farley	Contact Name:	Emma Humphreys
Tel: 0163540748	Fax: N/A	Mobile: 07468535836	

Lead Surveyor's Name:	Lead Surveyor's Authorising Signature:
N. Evans	

Document Name	Author	Issued by	Revision Number	Issue Date	Page No
2019	Kacey Lillis	Armour AS	0	29/11/2019	3

## Section 2: Executive Summary

No samples were taken during this survey

Document Name	Author	Issued by	Revision Number	Issue Date	Page No
2019	Kacey Lillis	Armour AS	0	29/11/2019	4



## Section 3: Site Description & Survey Information

### Brief description on the general building construction

Part of A Large Shopping Centre.

### Caveat for no access areas

N/A

### EXTERNAL MATERIALS

Roof Type	N/A
Roof Materials	N/A
Soffits	N/A
Fascia	Plastic, Metal, Wood
Walls	Brick/Block
Verge Under cloaking	N/A
Guttering	N/A
Downpipes	Metal
Window/Door frames	Wood, Metal
Other Materials	N/A

### INTERNAL MATERIALS

Loft Insulation	N/A
Roof Underlining	N/A
Ceilings	Plasterboard
Walls <i>Internal</i>	Plasterboard, Brick/Block
Floors	Concrete, Lino
Doors/Frames	Wood, Metal
Pipework/Insulation	Metal
Boxings	Wood, Metal
Boiler Make	N/A
Flue Pipes	Metal
Storage Heaters	N/A
Electrical Boxes/Machinery	Live
Ducting/Risers	N/A
Stairs	N/A
Lift Shafts	N/A
Other Materials	N/A

Document Name	Author	Issued by	Revision Number	Issue Date	Page No
2019	Kacey Lillis	Armour AS	0	29/11/2019	5

## Section 4: Positive and Presumed Photos Sheets

No positive or presumed items were found during this survey

Document Name	Author	Issued by	Revision Number	Issue Date	Page No
2019	Kacey Lillis	Armour AS	0	29/11/2019	6



Section 5: Negative Photos Sheets

Item No: 1	Sample No: N/A
Location: 0/001 Store	



Material Description:	Visual Inspection – No Suspect Materials Found	
Identification:	N/A	
Approx. quantity:	N/A	
Accessibility	N/A	Assessment Score
Product type:	N/A	N/A
Extent of Damage:	N/A	N/A
Surface Treatment:	N/A	N/A
Asbestos type:	N/A	N/A
Material Assessment Score:		N/A
Priority Assessment Score:		N/A
Action:	N/A	
Comments:	N/A	

Document Name	Author	Issued by	Revision Number	Issue Date	Page No
2019	Kacey Lillis	Armour AS	0	29/11/2019	7





Item No: 2

Sample No: N/A

Location: 0/002 WC



Material Description:	Visual Inspection – No Suspect Materials Found	
Identification:	N/A	
Approx. quantity:	N/A	
Accessibility	N/A	Assessment Score
Product type:	N/A	N/A
Extent of Damage:	N/A	N/A
Surface Treatment:	N/A	N/A
Asbestos type:	N/A	N/A
Material Assessment Score:		N/A
Priority Assessment Score:		N/A
Action:	N/A	
Comments:	N/A	

Document Name	Author	Issued by	Revision Number	Issue Date	Page No
2019	Kacey Lillis	Armour AS	0	29/11/2019	8



Item No: 3

Sample No: N/A

Location: 0/003



Material Description:	Visual Inspection – No Suspect Materials Found	
Identification:	N/A	
Approx. quantity:	N/A	
Accessibility	N/A	Assessment Score
Product type:	N/A	N/A
Extent of Damage:	N/A	N/A
Surface Treatment:	N/A	N/A
Asbestos type:	N/A	N/A
Material Assessment Score:		N/A
Priority Assessment Score:		N/A
Action:	N/A	
Comments:	N/A	

Document Name	Author	Issued by	Revision Number	Issue Date	Page No
2019	Kacey Lillis	Armour AS	0	29/11/2019	9



Item No: 4

Sample No: N/A

Location: 0/004



Material Description:	Visual Inspection – No Suspect Materials Found	
Identification:	N/A	
Approx. quantity:	N/A	
Accessibility	N/A	Assessment Score
Product type:	N/A	N/A
Extent of Damage:	N/A	N/A
Surface Treatment:	N/A	N/A
Asbestos type:	N/A	N/A
Material Assessment Score:		N/A
Priority Assessment Score:		N/A
Action:	N/A	
Comments:	N/A	

Document Name	Author	Issued by	Revision Number	Issue Date	Page No
2019	Kacey Lillis	Armour AS	0	29/11/2019	10



Item No: 5

Sample No: N/A

Location: 99/001 Externals



Material Description:	Visual Inspection – No Suspect Materials Found	
Identification:	N/A	
Approx. quantity:	N/A	
Accessibility	N/A	Assessment Score
Product type:	N/A	N/A
Extent of Damage:	N/A	N/A
Surface Treatment:	N/A	N/A
Asbestos type:	N/A	N/A
Material Assessment Score:		N/A
Priority Assessment Score:		N/A
Action:	N/A	
Comments:	N/A	

Document Name	Author	Issued by	Revision Number	Issue Date	Page No
2019	Kacey Lillis	Armour AS	0	29/11/2019	11



## Section 6: Survey Objectives

Instructions were received from James Croucher of Lochailort Newbury Ltd to carry out a Management asbestos survey at Kennet Centre, Market Street, Newbury, Berkshire, RG14 5EN in accordance with HSG264 and Armour Analytical's quality procedures.

The survey was carried out on 11<sup>th</sup> – 15<sup>th</sup> November 2019 by Neale Evans with the objective of facilitating a Management report.

This Management survey is characterised as a 'Visual Inspection Sampling and Identification Survey' in HSG264. This type of survey is used to locate and describe, so far as is reasonably practicable, all asbestos containing materials (ACMs) in the building and will by its nature involve the partial destruction of the building's fabric as access is gained to all areas. A full sampling programme is undertaken to identify possible ACMs and estimate the extent of ACMs reported.

The objective of this survey report is to identify, so far as is reasonably practicable, the location, extent, product type and composition of ACMS within the building to enable the building occupants to put management and remedial procedures in place.

Document Name	Author	Issued by	Revision Number	Issue Date	Page No
2019	Kacey Lillis	Armour AS	0	29/11/2019	12

## Section 7: Survey Techniques

Each floor, room and area within the scope was systematically inspected for suspect materials thought or known to contain asbestos and where such materials were encountered their location, extent, and composition were recorded.

Where materials of a similar nature exist, to those previously sampled, and a reasoned argument can be made that their composition is likely to be identical further physical sampling was not undertaken.

Photographs were taken of all sample locations, unless otherwise stated.

The analysis of suspect ACMs was undertaken by a UKAS accredited laboratory using the analytical method detailed in *HSG248, Appendix 2 -Asbestos: The analysts' guide for sampling, analysis and clearance procedures*.

Document Name	Author	Issued by	Revision Number	Issue Date	Page No
2019	Kacey Lillis	Armour AS	0	29/11/2019	13



## Section 8: Survey Caveat

This report is based upon a management report inspection of an unfamiliar site. During the course of the survey all reasonable efforts were made to identify the physical presence of materials containing asbestos within the building.

A Management Survey is a non-intrusive survey, meaning that access within the fabric of the building is limited. The survey does not include access to the following areas (unless agreed beforehand with the Client and provisions are put in place):

- Within wall or ceiling construction;
- Under fixed flooring;
- Within non-openable boxings;
- Within live electrics, boilers or machinery;
- Where access/visibility is limited in an area due to stored items, furniture or services;
- Areas where there is no safe access to inspect such as floor ducts, lift shafts and loft spaces with no crawlboards;
- High level areas that are too high to safely inspect.
- Within pipework insulation throughout building as this would affect the integrity of services.

Any intrusive works carried out within the building must first be subject to a Refurbishment Asbestos Survey.

This report will be restricted to the areas that fall within the scope of works for project and will **not take into account any area's that do not fall within the scope. Any asbestos that is identified** within this report will need to be added to the buildings existing information and should not form the basis for a management survey. This survey will not include priority assessments nor will it include a register.

This survey considered the construction of the building, associated fixtures & fittings and associated structures and in no way should it be considered as a ground investigation report.

Services should be disconnected prior to commencement of a Management survey; however, where plant and/or electrical installations are live or appear to be live then these will not be accessed.

This survey report is not a bill of quantities.

Document Name	Author	Issued by	Revision Number	Issue Date	Page No
2019	Kacey Lillis	Armour AS	0	29/11/2019	14

## Section 9: Survey Notes

This report has been written with reference to the various Guidance Notes etc, issued, and current at the date of this report and describes circumstances at the site on the date the investigation took place.

Where similar items exist in the building, only one or two samples have been taken to ascertain the material content. It was assumed that similar products were of the same material.

Any person undertaking work within the buildings should be told of the presence of asbestos. This briefing also applies to any other person associated with the site, including staff, sub-contractors and others.

The drawings in the report are not to scale and are illustrative only to indicate approximate locations. The descriptions used are for location identification purposes.

All the recommendations described in this report are based upon assumptions made after consideration of the type of material, condition of the material, its location, analysis result and type of use the area is thought to be subjected to. However, statutory authorities or others could require amendments based on local knowledge, change in legislation, change in use or indeed other conditions or criteria.

Samples taken from floor tiles (or similar material) may include a bitumen adhesive as part of the sample. It is known that some proprietary brands of bitumen have an asbestos content and this will be included as an integral part of the bulk sample unless otherwise stated.

Document Name	Author	Issued by	Revision Number	Issue Date	Page No
2019	Kacey Lillis	Armour AS	0	29/11/2019	15



## Section 10: Material Assessment Algorithm

Variable	Score	Examples
Installation / Product type	1	<b>Vinyl, 'Bakelite', Cement</b>
	2	Asbestos insulating board, paper, rope
	3	Pipe insulation, spray coating, friable debris
Condition / damage	0	Good
	1	Slight / minor damage
	2	Moderate damage – breakage to surface treatment
	3	Major damage – smashed or exposed material
Surface treatment	0	Non-friable e.g. vinyl
	1	Enclosed insulation, encapsulated AIB
	2	Unsealed AIB, encapsulated insulation
	3	Unsealed insulation or spray coating
Asbestos type	1	Chrysotile
	2	Amosite & other amphiboles
	3	Crocidolite

The scores from each of the four sections are added together to produce a risk score:

Risk score	Risk assessment
10 or more	High risk
7 – 9	Medium risk
5 – 6	Low risk
4 & below	Negligible risk

Document Name	Author	Issued by	Revision Number	Issue Date	Page No
2019	Kacey Lillis	Armour AS	0	29/11/2019	16







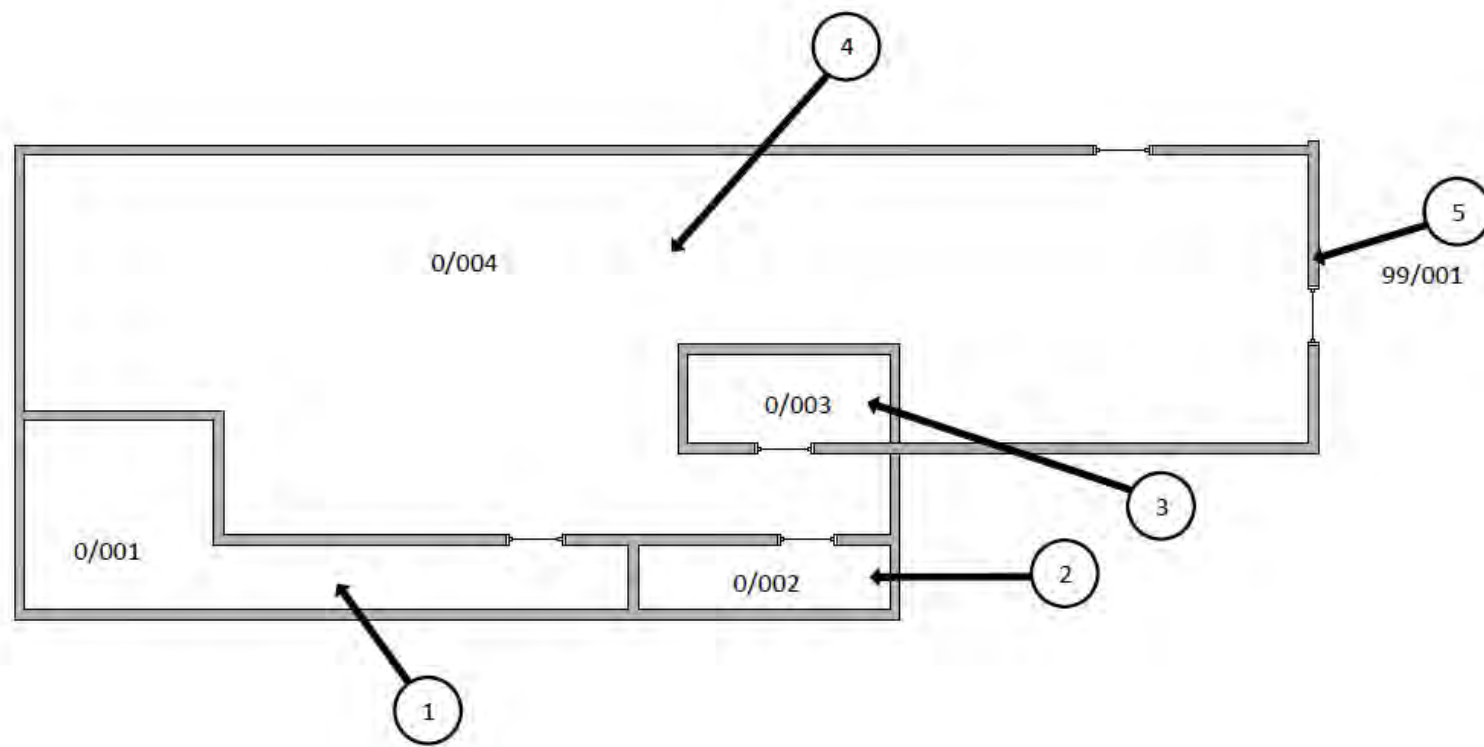

## Section 11: Certificates of Bulk Analysis

No samples were taken during this survey

Document Name	Author	Issued by	Revision Number	Issue Date	Page No
2019	Kacey Lillis	Armour AS	0	29/11/2019	17

## Section 12: Site Plan



Key	
	Visual Inspection
	Asbestos Detected (Positive Item)
	No Asbestos Detected (Negative Item)
	Presumed to Contain Asbestos
	Strongly Presumed to Contain Asbestos
	No Access

Document Name	Author	Issued by	Revision Number	Issue Date	Page No
2019	Kacey Lillis	Armour AS	0	29/11/2019	18



I the surveyor can confirm that this report is accurate to my findings onsite and this survey has been Content checked by myself.

Checked by: Neale Evans

Date: 28.11.2019

I the Admin Manager can confirm that this report is accurate to the paperwork received and this survey has been quality checked by myself.

Checked by: Emma Humphreys

Date: 26.11.2019

Report Compiled By

Armour Analytical Services Ltd, Admirals Yard, Station Road, Bristol, BS34 6LR

Document Name	Author	Issued by	Revision Number	Issue Date	Page No
2019	Kacey Lillis	Armour AS	0	29/11/2019	19



Project Number 3113

Management  
Asbestos Survey Report

Kennet Centre, Market Street, Newbury,  
Berkshire, RG14 5EN

Centre Management Office



*Working in Partnership with Shield Environmental Services* 

Document Name	Author	Issued by	Revision Number	Issue Date	Page No
2019	Emma Humphreys	Armour AS	0	29/11/2019	1



## Contents

Section	
1	Contacts & Authorisation
2	Executive Summary
3	Site Description & Survey Information
4	Positive and Presumed Photos Sheets
5	Negative Photos Sheets
6	Survey Objectives
7	Survey Techniques
8	Survey Caveat
9	Survey Notes
10	Material Assessment Algorithm
11	Certificates of Bulk Analysis
12	Site Plan

Document Name	Author	Issued by	Revision Number	Issue Date	Page No
2019	Emma Humphreys	Armour AS	0	29/11/2019	2



## Section 1: Contact Details

Client Details:		Instructing Party:	
Lochailort Newbury Ltd Eagle House 108-110 Jermyn Street London SW1Y 6EE		Lochailort Newbury Ltd Eagle House 108-110 Jermyn Street London SW1Y 6EE	
Contact Name:	James Croucher	Contact Name:	James Croucher
Tel: 07590397181	Fax: N/A	Tel: 07590397181	Fax: N/A

Site Address:		Report Author:	
Kennet Centre Market Street Newbury Berkshire RG14 5EN		Armour Analytical Services Admirals Yard Station Road Bristol BS34 6LR	
Contact Name:	Richard Farley	Contact Name:	Emma Humphreys
Tel: 0163540748	Fax: N/A	Mobile: 07468535836	

Lead Surveyor's Name:	Lead Surveyor's Authorising Signature:
N. Evans	

Document Name	Author	Issued by	Revision Number	Issue Date	Page No
2019	Emma Humphreys	Armour AS	0	29/11/2019	3



## Section 2: Executive Summary

Sample Number	Sample Type	Location	Analysis
NE/1	Bitumen Adhesive	Ground Floor, 002 Office	Chrysotile
NE/2	Vinyl Floor Tiles	Ground Floor, 005 Kitchen	Chrysotile

A.D – Asbestos Detected

Document Name	Author	Issued by	Revision Number	Issue Date	Page No
2019	Emma Humphreys	Armour AS	0	29/11/2019	4





## Section 3: Site Description & Survey Information

### Brief description on the general building construction

Part of a large shopping Centre, Flat concrete roof with bitumen felt sheets, brick building.

### Caveat for no access areas

All areas accessed.

### EXTERNAL MATERIALS

Roof Type	Flat
Roof Materials	Concrete, Bitumen Felt, Wood
Soffits	N/A
Fascia	N/A
Walls	Brick
Verge Under cloaking	N/A
Guttering	Plastic
Downpipes	Metal
Window/Door frames	Metal, Wood
Other Materials	N/A

### INTERNAL MATERIALS

Loft Insulation	N/A
Roof Underlining	Concrete
Ceilings	Concrete, MMMF tiles, Wood
Walls <i>Internal</i>	Plaster on Masonry
Floors	Concrete
Doors/Frames	Wood
Pipework/Insulation	Metal
Boxings	Plasterboard
Boiler Make	N/A
Flue Pipes	N/A
Storage Heaters	N/A
Electrical Boxes/Machinery	Live – Modern electrics
Ducting/Risers	N/A
Stairs	N/A
Lift Shafts	N/A
Other Materials	N/A

Document Name	Author	Issued by	Revision Number	Issue Date	Page No
2019	Emma Humphreys	Armour AS	0	29/11/2019	5



Section 4: Positive and Presumed Photos Sheets

Item No: 2	Sample No: NE/1
Location: 0/002 – Office	



Material Description:	Bitumen Adhesive Floor	
Identification:	Sampled – Asbestos Detected	
Approx. quantity:	20M2	
Accessibility	Low	Assessment Score
Product type:	Bitumen	1
Extent of Damage:	Minor	1
Surface Treatment:	Non-Friable	0
Asbestos type:	Chrysotile	1
Material Assessment Score:		3
Priority Assessment Score:		Negligible
Action:	Manage	
Comments:	N/A	

Document Name	Author	Issued by	Revision Number	Issue Date	Page No
2019	Emma Humphreys	Armour AS	0	29/11/2019	6



Item No: 5

Sample No: NE/2

Location: 0/005 - Kitchen



Material Description:	Vinyl Floor Tiles	
Identification:	Sampled - Asbestos Detected	
Approx. quantity:	2M2	
Accessibility	Low	Assessment Score
Product type:	Vinyl	1
Extent of Damage:	Minor	1
Surface Treatment:	Non-Friable	0
Asbestos type:	Chrysotile	1
Material Assessment Score:		3
Priority Assessment Score:		Negligible
Action:	Manage	
Comments:	N/A	

Document Name	Author	Issued by	Revision Number	Issue Date	Page No
2019	Emma Humphreys	Armour AS	0	29/11/2019	7



Section 5: Negative Photos Sheets

Item No: 1	Sample No: N/A
Location: 0/001 – Entrance	



Material Description:	Visual Inspection – No Suspect Materials Found	
Identification:	N/A	
Approx. quantity:	N/A	
Accessibility	N/A	Assessment Score
Product type:	N/A	N/A
Extent of Damage:	N/A	N/A
Surface Treatment:	N/A	N/A
Asbestos type:	N/A	N/A
Material Assessment Score:		N/A
Priority Assessment Score:		N/A
Action:	N/A	
Comments:	N/A	

Document Name	Author	Issued by	Revision Number	Issue Date	Page No
2019	Emma Humphreys	Armour AS	0	29/11/2019	8



Item No: 3

Sample No: N/A

Location: 0/003 – Office



Material Description:	Visual Inspection – No Suspect Materials Found	
Identification:	N/A	
Approx. quantity:	N/A	
Accessibility	N/A	Assessment Score
Product type:	N/A	N/A
Extent of Damage:	N/A	N/A
Surface Treatment:	N/A	N/A
Asbestos type:	N/A	N/A
Material Assessment Score:		N/A
Priority Assessment Score:		N/A
Action:	N/A	
Comments:	N/A	

Document Name	Author	Issued by	Revision Number	Issue Date	Page No
2019	Emma Humphreys	Armour AS	0	29/11/2019	9



Item No: 4

Sample No: N/A

Location: 0/004 – Security Room



Material Description:	Visual Inspection – No Suspect Materials Found	
Identification:	N/A	
Approx. quantity:	N/A	
Accessibility	N/A	Assessment Score
Product type:	N/A	N/A
Extent of Damage:	N/A	N/A
Surface Treatment:	N/A	N/A
Asbestos type:	N/A	N/A
Material Assessment Score:		N/A
Priority Assessment Score:		N/A
Action:	N/A	
Comments:	N/A	

Document Name	Author	Issued by	Revision Number	Issue Date	Page No
2019	Emma Humphreys	Armour AS	0	29/11/2019	10



Item No: 6

Sample No: N/A

Location: 0/006 - WC



Material Description:	Visual Inspection – No Suspect Materials Found	
Identification:	N/A	
Approx. quantity:	N/A	
Accessibility	N/A	Assessment Score
Product type:	N/A	N/A
Extent of Damage:	N/A	N/A
Surface Treatment:	N/A	N/A
Asbestos type:	N/A	N/A
Material Assessment Score:		N/A
Priority Assessment Score:		N/A
Action:	N/A	
Comments:	N/A	

Document Name	Author	Issued by	Revision Number	Issue Date	Page No
2019	Emma Humphreys	Armour AS	0	29/11/2019	11



Item No: 7

Sample No: N/A

Location: 0/007 - WC



Material Description:	Visual Inspection – No Suspect Materials Found	
Identification:	N/A	
Approx. quantity:	N/A	
Accessibility	N/A	Assessment Score
Product type:	N/A	N/A
Extent of Damage:	N/A	N/A
Surface Treatment:	N/A	N/A
Asbestos type:	N/A	N/A
Material Assessment Score:		N/A
Priority Assessment Score:		N/A
Action:	N/A	
Comments:	N/A	

Document Name	Author	Issued by	Revision Number	Issue Date	Page No
2019	Emma Humphreys	Armour AS	0	29/11/2019	12





Item No: 8

Sample No: N/A

Location: 0/008 – Cupboard



Material Description:	Visual Inspection – No Suspect Materials Found	
Identification:	N/A	
Approx. quantity:	N/A	
Accessibility	N/A	Assessment Score
Product type:	N/A	N/A
Extent of Damage:	N/A	N/A
Surface Treatment:	N/A	N/A
Asbestos type:	N/A	N/A
Material Assessment Score:		N/A
Priority Assessment Score:		N/A
Action:	N/A	
Comments:	N/A	

Document Name	Author	Issued by	Revision Number	Issue Date	Page No
2019	Emma Humphreys	Armour AS	0	29/11/2019	13



Item No: 9

Sample No: N/A

Location: 0/009 – Electrical Room



Material Description:	Visual Inspection – No Suspect Materials Found	
Identification:	N/A	
Approx. quantity:	N/A	
Accessibility	N/A	Assessment Score
Product type:	N/A	N/A
Extent of Damage:	N/A	N/A
Surface Treatment:	N/A	N/A
Asbestos type:	N/A	N/A
Material Assessment Score:		N/A
Priority Assessment Score:		N/A
Action:	N/A	
Comments:	N/A	

Document Name	Author	Issued by	Revision Number	Issue Date	Page No
2019	Emma Humphreys	Armour AS	0	29/11/2019	14



Item No: 10

Sample No: N/A

Location: 99/001 – External



Material Description:	Visual Inspection – No Suspect Materials Found	
Identification:	N/A	
Approx. quantity:	N/A	
Accessibility	N/A	<i>Assessment Score</i>
Product type:	N/A	N/A
Extent of Damage:	N/A	N/A
Surface Treatment:	N/A	N/A
Asbestos type:	N/A	N/A
Material Assessment Score:		N/A
Priority Assessment Score:		N/A
Action:	N/A	
Comments:	N/A	

Document Name	Author	Issued by	Revision Number	Issue Date	Page No
2019	Emma Humphreys	Armour AS	0	29/11/2019	15



## Section 6: Survey Objectives

Instructions were received from James Croucher of Lochailort Newbury Ltd to carry out a Management asbestos survey at Kennet Centre, Market Street, Newbury, Berkshire, RG14 5EN in accordance with HSG264 and Armour Analytical's quality procedures.

The survey was carried out on 4<sup>th</sup> – 8<sup>th</sup> November 2019 by Neale Evans with the objective of facilitating a Management report.

This Management survey is characterised as a 'Visual Inspection Sampling and Identification Survey' in HSG264. This type of survey is used to locate and describe, so far as is reasonably practicable, all asbestos containing materials (ACMs) in the building and will by its nature involve the partial destruction of the building's fabric as access is gained to all areas. A full sampling programme is undertaken to identify possible ACMs and estimate the extent of ACMs reported.

The objective of this survey report is to identify, so far as is reasonably practicable, the location, extent, product type and composition of ACMS within the building to enable the building occupants to put management and remedial procedures in place.

Document Name	Author	Issued by	Revision Number	Issue Date	Page No
2019	Emma Humphreys	Armour AS	0	29/11/2019	16

## Section 7: Survey Techniques

Each floor, room and area within the scope was systematically inspected for suspect materials thought or known to contain asbestos and where such materials were encountered their location, extent, and composition were recorded.

Where materials of a similar nature exist, to those previously sampled, and a reasoned argument can be made that their composition is likely to be identical further physical sampling was not undertaken.

Photographs were taken of all sample locations, unless otherwise stated.

The analysis of suspect ACMs was undertaken by a UKAS accredited laboratory using the analytical method detailed in *HSG248, Appendix 2 -Asbestos: The analysts' guide for sampling, analysis and clearance procedures*.

Document Name	Author	Issued by	Revision Number	Issue Date	Page No
2019	Emma Humphreys	Armour AS	0	29/11/2019	17



## Section 8: Survey Caveat

This report is based upon a management report inspection of an unfamiliar site. During the course of the survey all reasonable efforts were made to identify the physical presence of materials containing asbestos within the building.

A Management Survey is a non-intrusive survey, meaning that access within the fabric of the building is limited. The survey does not include access to the following areas (unless agreed beforehand with the Client and provisions are put in place):

- Within wall or ceiling construction;
- Under fixed flooring;
- Within non-openable boxings;
- Within live electrics, boilers or machinery;
- Where access/visibility is limited in an area due to stored items, furniture or services;
- Areas where there is no safe access to inspect such as floor ducts, lift shafts and loft spaces with no crawlboards;
- High level areas that are too high to safely inspect.
- Within pipework insulation throughout building as this would affect the integrity of services.

Any intrusive works carried out within the building must first be subject to a Refurbishment Asbestos Survey.

This report will be restricted to the areas that fall within the scope of works for project and will **not take into account any area's that do not fall within the scope. Any asbestos that** is identified within this report will need to be added to the buildings existing information and should not form the basis for a management survey. This survey will not include priority assessments nor will it include a register.

This survey considered the construction of the building, associated fixtures & fittings and associated structures and in no way should it be considered as a ground investigation report.

Services should be disconnected prior to commencement of a Management survey; however, where plant and/or electrical installations are live or appear to be live then these will not be accessed.

This survey report is not a bill of quantities.

Document Name	Author	Issued by	Revision Number	Issue Date	Page No
2019	Emma Humphreys	Armour AS	0	29/11/2019	18



## Section 9: Survey Notes

This report has been written with reference to the various Guidance Notes etc, issued, and current at the date of this report and describes circumstances at the site on the date the investigation took place.

Where similar items exist in the building, only one or two samples have been taken to ascertain the material content. It was assumed that similar products were of the same material.

Any person undertaking work within the buildings should be told of the presence of asbestos. This briefing also applies to any other person associated with the site, including staff, sub-contractors and others.

The drawings in the report are not to scale and are illustrative only to indicate approximate locations. The descriptions used are for location identification purposes.

All the recommendations described in this report are based upon assumptions made after consideration of the type of material, condition of the material, its location, analysis result and type of use the area is thought to be subjected to. However, statutory authorities or others could require amendments based on local knowledge, change in legislation, change in use or indeed other conditions or criteria.

Samples taken from floor tiles (or similar material) may include a bitumen adhesive as part of the sample. It is known that some proprietary brands of bitumen have an asbestos content and this will be included as an integral part of the bulk sample unless otherwise stated.

Document Name	Author	Issued by	Revision Number	Issue Date	Page No
2019	Emma Humphreys	Armour AS	0	29/11/2019	19



## Section 10: Material Assessment Algorithm

Variable	Score	Examples
Installation / Product type	1	<b>Vinyl, 'Bakelite', Cement</b>
	2	Asbestos insulating board, paper, rope
	3	Pipe insulation, spray coating, friable debris
Condition / damage	0	Good
	1	Slight / minor damage
	2	Moderate damage – breakage to surface treatment
	3	Major damage – smashed or exposed material
Surface treatment	0	Non-friable e.g. vinyl
	1	Enclosed insulation, encapsulated AIB
	2	Unsealed AIB, encapsulated insulation
	3	Unsealed insulation or spray coating
Asbestos type	1	Chrysotile
	2	Amosite & other amphiboles
	3	Crocidolite

The scores from each of the four sections are added together to produce a risk score:

Risk score	Risk assessment
10 or more	High risk
7 – 9	Medium risk
5 – 6	Low risk
4 & below	Negligible risk

Document Name	Author	Issued by	Revision Number	Issue Date	Page No
2019	Emma Humphreys	Armour AS	0	29/11/2019	20





## Section 11: Certificates of Bulk Analysis



Our Ref: J179496 FI: 2  
Your Ref: 3113  
Date: 13/11/2019

**ENVIROCHEM**  
Analytical Laboratories Ltd.  
12 The Gardens  
Broadcut, Fareham  
Hampshire  
PO16 8SS



Tel: (01329) 287777  
Fax: (01329) 287755  
www.envirochem.co.uk  
office@envirochem.co.uk

### Asbestos Fibre Identification Report

**Client:** Armour Analytical Services Ltd  
Admirals Yard, Station Road, Patchway, Bristol, BS34 6LR

**Site Address:** Kennet Centre Market Place, Centre Management Office, Newbury, RG14 5EN

**Sampled By:** Armour Analytical Services Ltd

**Date sampled/received:** 13th November 2019

**Date analysed:** 13th November 2019

**Analyst/s:** Ewelina Kowalczyk Pariyar

**Analysis Location:** 12 The Gardens, Broadcut, Fareham, Hampshire, PO16 8SS

#### ANALYTICAL PROCEDURE

Fibre identification was carried out in accordance with the documented 'in-house' method (2.01) based on the HSE Guidance Note HSG 248. These employed stereo microscopy, polarized microscopy and dispersion staining techniques.

#### RESULTS

Sample No.	Sample Ref.	Location	Asbestos Detected	Asbestos Type
NE/1	BS586090	Ground Floor, 002 Office - Bitumen Adhesive	Yes	Chrysotile
NE/2	BS586091	Ground Floor, 005 Kitchen - Vinyl Floor Tiles	Yes	Chrysotile

#### NOTES:

1. Sample(s) were examined for the presence of 6 types of asbestos fibre: crocidolite (blue), amosite (brown), chrysotile (white), anthrophyllite, actinolite and tremolite.
2. The results shown in this test report specifically refer to the sample(s) tested as received unless otherwise stated and samples collected by the client are evaluated using information provided by the client. For samples collected by the client the date of receipt is deemed to be the same as the date sampled.
3. Envirochem is a UKAS accredited laboratory for sampling and identification of asbestos containing materials.
4. Comments, observations and opinions are outside the scope of UKAS accreditation.
5. The analytical method in the HSG 248 does not quantify the amount of asbestos present, therefore UKAS accreditation does not permit quantification.
6. If, during fibre identification, only 1 or 2 fibres are seen and identified as asbestos, then the term 'trace asbestos identified' is used.
7. This report shall not be reproduced except in full, without written approval of Envirochem.

SIGNATURE: *Kowalczyk*

Authorised signatory

PRINT NAME: Ewelina Kowalczyk Pariyar





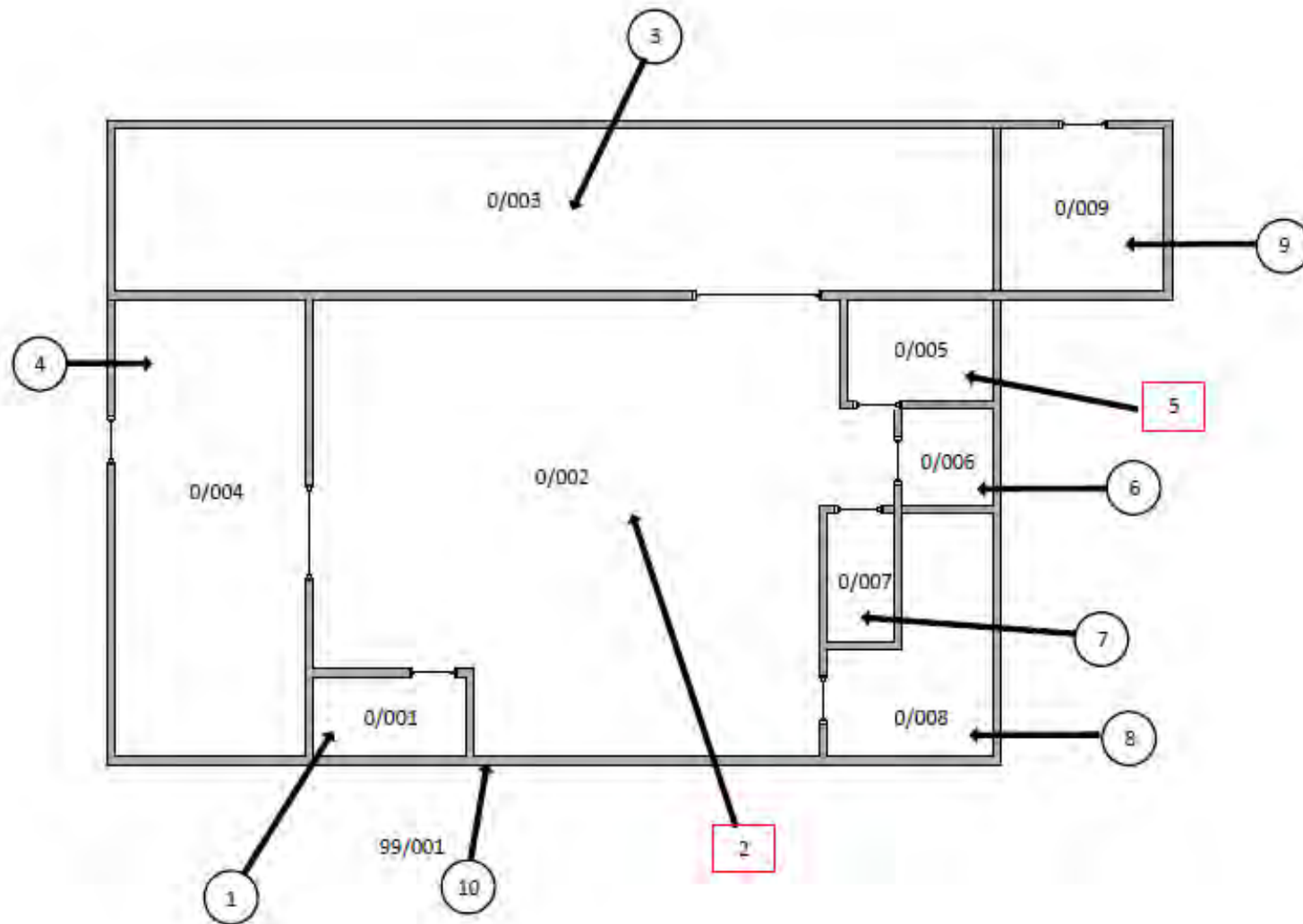

Reg. No. 2378228 England. Registered Office: Envirochem, 12 The Gardens, Broadcut, Fareham, Hampshire, PO16 8SS.

Page 1 of 1

Document Name	Author	Issued by	Revision Number	Issue Date	Page No
2019	Emma Humphreys	Armour AS	0	29/11/2019	21

## Section 12: Site Plan



Key	
	Visual Inspection
	Asbestos Detected (Positive Item)
	No Asbestos Detected (Negative Item)
	Presumed to Contain Asbestos
	Strongly Presumed to Contain Asbestos
	No Access

Document Name	Author	Issued by	Revision Number	Issue Date	Page No
2019	Emma Humphreys	Armour AS	0	29/11/2019	22



I the surveyor can confirm that this report is accurate to my findings onsite and this survey has been Content checked by myself.

Checked by: Neale Evans

Date: 28.11.2019

I the Admin Manager can confirm that this report is accurate to the paperwork received and this survey has been quality checked by myself.

Checked by: Emma Humphreys

Date: 22.11.2019

Report Compiled By

Armour Analytical Services Ltd, Admirals Yard, Station Road, Bristol, BS34 6LR

Document Name	Author	Issued by	Revision Number	Issue Date	Page No
2019	Emma Humphreys	Armour AS	0	29/11/2019	23



Project Number 3113

Management  
Asbestos Survey Report

Kennet Centre, Market Street, Newbury,  
Berkshire, RG14 5EN

143-145 Bartholomew Street



*Working in Partnership with Shield Environmental Services*



Document Name	Author	Issued by	Revision Number	Issue Date	Page No
2019	Kacey Lillis	Armour AS	0	29/11/2019	1



## Contents

Section	
1	Contacts & Authorisation
2	Executive Summary
3	Site Description & Survey Information
4	Positive and Presumed Photos Sheets
5	Negative Photos Sheets
6	Survey Objectives
7	Survey Techniques
8	Survey Caveat
9	Survey Notes
10	Material Assessment Algorithm
11	Certificates of Bulk Analysis
12	Site Plan

Document Name	Author	Issued by	Revision Number	Issue Date	Page No
2019	Kacey Lillis	Armour AS	0	29/11/2019	2



## Section 1: Contact Details

Client Details:		Instructing Party:	
Lochailort Newbury Ltd Eagle House 108-110 Jermyn Street London SW1Y 6EE		Lochailort Newbury Ltd Eagle House 108-110 Jermyn Street London SW1Y 6EE	
Contact Name:	James Croucher	Contact Name:	James Croucher
Tel: 07590397181	Fax: N/A	Tel: 07590397181	Fax: N/A

Site Address:		Report Author:	
Kennet Centre Market Street Newbury Berkshire RG14 5EN		Armour Analytical Services Admirals Yard Station Road Bristol BS34 6LR	
Contact Name:	Richard Farley	Contact Name:	Emma Humphreys
Tel: 0163540748	Fax: N/A	Mobile: 07468535836	

Lead Surveyor's Name:	Lead Surveyor's Authorising Signature:
N. Evans	

Document Name	Author	Issued by	Revision Number	Issue Date	Page No
2019	Kacey Lillis	Armour AS	0	29/11/2019	3

## Section 2: Executive Summary

Sample Number	Sample Type	Location	Analysis
NE/1	Vinyl Floor Tiles	First Floor – 003 WC	N.A.D.I.S
NE/2	Sink Pad	First Floor – 005 Kitchen	Chrysotile

N.A.D.I.S – No Asbestos Detected in Sample

A.D – Asbestos Detected

In addition to the above sampled items, the following items have been either been “Strongly Presumed” To Contain Asbestos or “Presumed” to Contain Asbestos as they were either visually identified in being so, labelled after previously being sampled on prior surveys or not accessible at the time of the survey:

Item 2 - 1/002 – Lift – No Access as no lift engineer was onsite

Item 12 - Lift and Lift Shaft – No Access as no lift engineer was onsite

The presence of asbestos in these areas cannot be ascertained at this time. If any works are to be carried out in these areas in the future, then these works should be approached cautiously.

In accordance with current legislation, any suspect materials encountered in these areas are to be assumed to contain asbestos until proven otherwise. This will normally involve cessation of works in the affected area.

Document Name	Author	Issued by	Revision Number	Issue Date	Page No
2019	Kacey Lillis	Armour AS	0	29/11/2019	4



## Section 3: Site Description & Survey Information

### Brief description on the general building construction

Part of A Large Shopping Centre, Brick/Block, Pitched Metal Roof.

### Caveat for no access areas

No Access to Lift or Shaft.

### EXTERNAL MATERIALS

Roof Type	Pitched
Roof Materials	Metal
Soffits	N/A
Fascia	Metal
Walls	Brick
Verge Under cloaking	N/A
Guttering	Plastic
Downpipes	Plastic, Metal
Window/Door frames	Metal, Wood
Other Materials	N/A

### INTERNAL MATERIALS

Loft Insulation	N/A
Roof Underlining	Metal
Ceilings	Metal, Concrete
Walls <i>Internal</i>	Block, Plasterboard
Floors	Concrete
Doors/Frames	Wood, Metal
Pipework/Insulation	Metal
Boxings	Wood
Boiler Make	Ariston Heat Store
Flue Pipes	Metal
Storage Heaters	N/A
Electrical Boxes/Machinery	Live
Ducting/Risers	N/A
Stairs	Concrete
Lift Shafts	No Access
Other Materials	Rubber Step Nosing

Document Name	Author	Issued by	Revision Number	Issue Date	Page No
2019	Kacey Lillis	Armour AS	0	29/11/2019	5





Section 4: Positive and Presumed Photos Sheets

Item No: 2	Sample No: N/A
Location: 1/002	



Material Description:	No Access	
Identification:	Presumed to Contain asbestos	
Approx. quantity:	X 1 Lift	
Accessibility	Medium	<i>Assessment Score</i>
Product type:	No Access	3
Extent of Damage:	No Access	3
Surface Treatment:	No Access	3
Asbestos type:	No Access	3
Material Assessment Score:		12
Priority Assessment Score:		High
Action:	Further Inspection Required	
Comments:	Unable to gain access as no lift engineer was onsite	

Document Name	Author	Issued by	Revision Number	Issue Date	Page No
2019	Kacey Lillis	Armour AS	0	29/11/2019	6



Item No: 6

Sample No: NE/2

Location: 1/005 Kitchen



Material Description:	Sink Pad	
Identification:	Sampled - Asbestos Detected	
Approx. quantity:	X 2	
Accessibility	Low	Assessment Score
Product type:	Bitumen	1
Extent of Damage:	Moderate	2
Surface Treatment:	Non-Friable	0
Asbestos type:	Chrysotile	1
Material Assessment Score:		4
Priority Assessment Score:		Negligible
Action:	Manage	
Comments:	N/A	

Document Name	Author	Issued by	Revision Number	Issue Date	Page No
2019	Kacey Lillis	Armour AS	0	29/11/2019	7



Item No: 12

Sample No: N/A

Location: Lift and Shaft



Material Description:	No Access	
Identification:	Presumed to Contain asbestos	
Approx. quantity:	X 1 Lift and Shaft	
Accessibility	Low	Assessment Score
Product type:	No Access	3
Extent of Damage:	No Access	3
Surface Treatment:	No Access	3
Asbestos type:	No Access	3
Material Assessment Score:		12
Priority Assessment Score:		High
Action:	Further Inspection Required	
Comments:	Unable to gain access as no lift engineer was onsite	

Document Name	Author	Issued by	Revision Number	Issue Date	Page No
2019	Kacey Lillis	Armour AS	0	29/11/2019	8



Section 5: Negative Photos Sheets

Item No: 1	Sample No: N/A
Location: 1/001 Store	



Material Description:	Visual Inspection – No Suspect Materials Found	
Identification:	N/A	
Approx. quantity:	N/A	
Accessibility	N/A	Assessment Score
Product type:	N/A	N/A
Extent of Damage:	N/A	N/A
Surface Treatment:	N/A	N/A
Asbestos type:	N/A	N/A
Material Assessment Score:		N/A
Priority Assessment Score:		N/A
Action:	N/A	
Comments:	N/A	

Document Name	Author	Issued by	Revision Number	Issue Date	Page No
2019	Kacey Lillis	Armour AS	0	29/11/2019	9



Item No: 3

Sample No: NE/1

Location: 0/003 WC



Material Description:	Vinyl Floor Tiles	
Identification:	Sampled - No Asbestos Detected	
Approx. quantity:	4M2	
Accessibility	N/A	Assessment Score
Product type:	N/A	N/A
Extent of Damage:	N/A	N/A
Surface Treatment:	N/A	N/A
Asbestos type:	N/A	N/A
Material Assessment Score:		N/A
Priority Assessment Score:		N/A
Action:	N/A	
Comments:	N/A	

Document Name	Author	Issued by	Revision Number	Issue Date	Page No
2019	Kacey Lillis	Armour AS	0	29/11/2019	10



Item No: 4

Sample No: N/A

Location: 0/004 WC



Material Description:	Vinyl Floor Tiles	
Identification:	As Per Sample NE/1- No Asbestos Detected	
Approx. quantity:	4M2	
Accessibility	N/A	Assessment Score
Product type:	N/A	N/A
Extent of Damage:	N/A	N/A
Surface Treatment:	N/A	N/A
Asbestos type:	N/A	N/A
Material Assessment Score:		N/A
Priority Assessment Score:		N/A
Action:	N/A	
Comments:	N/A	

Document Name	Author	Issued by	Revision Number	Issue Date	Page No
2019	Kacey Lillis	Armour AS	0	29/11/2019	11



Item No: 5

Sample No: N/A

Location: 1/005 Kitchen



Material Description:	Vinyl Floor Tiles	
Identification:	As Per Sample NE/1- No Asbestos Detected	
Approx. quantity:	8M2	
Accessibility	N/A	Assessment Score
Product type:	N/A	N/A
Extent of Damage:	N/A	N/A
Surface Treatment:	N/A	N/A
Asbestos type:	N/A	N/A
Material Assessment Score:		N/A
Priority Assessment Score:		N/A
Action:	N/A	
Comments:	N/A	

Document Name	Author	Issued by	Revision Number	Issue Date	Page No
2019	Kacey Lillis	Armour AS	0	29/11/2019	12



Item No: 7

Sample No: N/A

Location: 1/006 Stores



Material Description:	Visual Inspection – No Suspect Materials Found	
Identification:	N/A	
Approx. quantity:	N/A	
Accessibility	N/A	Assessment Score
Product type:	N/A	N/A
Extent of Damage:	N/A	N/A
Surface Treatment:	N/A	N/A
Asbestos type:	N/A	N/A
Material Assessment Score:		N/A
Priority Assessment Score:		N/A
Action:	N/A	
Comments:	N/A	

Document Name	Author	Issued by	Revision Number	Issue Date	Page No
2019	Kacey Lillis	Armour AS	0	29/11/2019	13





Item No: 8

Sample No: N/A

Location: 1/007 Stores



Material Description:	Visual Inspection – No Suspect Materials Found	
Identification:	N/A	
Approx. quantity:	N/A	
Accessibility	N/A	Assessment Score
Product type:	N/A	N/A
Extent of Damage:	N/A	N/A
Surface Treatment:	N/A	N/A
Asbestos type:	N/A	N/A
Material Assessment Score:		N/A
Priority Assessment Score:		N/A
Action:	N/A	
Comments:	N/A	

Document Name	Author	Issued by	Revision Number	Issue Date	Page No
2019	Kacey Lillis	Armour AS	0	29/11/2019	14



Item No: 9

Sample No: N/A

Location: 1/008 Electric Room



Material Description:	Visual Inspection – No Suspect Materials Found	
Identification:	N/A	
Approx. quantity:	N/A	
Accessibility	N/A	Assessment Score
Product type:	N/A	N/A
Extent of Damage:	N/A	N/A
Surface Treatment:	N/A	N/A
Asbestos type:	N/A	N/A
Material Assessment Score:		N/A
Priority Assessment Score:		N/A
Action:	N/A	
Comments:	N/A	

Document Name	Author	Issued by	Revision Number	Issue Date	Page No
2019	Kacey Lillis	Armour AS	0	29/11/2019	15



Item No: 10

Sample No: N/A

Location: 1/009 Stairs



Material Description:	Visual Inspection – No Suspect Materials Found	
Identification:	N/A	
Approx. quantity:	N/A	
Accessibility	N/A	Assessment Score
Product type:	N/A	N/A
Extent of Damage:	N/A	N/A
Surface Treatment:	N/A	N/A
Asbestos type:	N/A	N/A
Material Assessment Score:		N/A
Priority Assessment Score:		N/A
Action:	N/A	
Comments:	N/A	

Document Name	Author	Issued by	Revision Number	Issue Date	Page No
2019	Kacey Lillis	Armour AS	0	29/11/2019	16



Item No: 11

Sample No: N/A

Location: 0/001 Shop Floor



Material Description:	Visual Inspection – No Suspect Materials Found	
Identification:	N/A	
Approx. quantity:	N/A	
Accessibility	N/A	Assessment Score
Product type:	N/A	N/A
Extent of Damage:	N/A	N/A
Surface Treatment:	N/A	N/A
Asbestos type:	N/A	N/A
Material Assessment Score:		N/A
Priority Assessment Score:		N/A
Action:	N/A	
Comments:	N/A	

Document Name	Author	Issued by	Revision Number	Issue Date	Page No
2019	Kacey Lillis	Armour AS	0	29/11/2019	17



Item No: 13

Sample No: N/A

Location: 0/003 Cupboard



Material Description:	Visual Inspection – No Suspect Materials Found	
Identification:	N/A	
Approx. quantity:	N/A	
Accessibility	N/A	Assessment Score
Product type:	N/A	N/A
Extent of Damage:	N/A	N/A
Surface Treatment:	N/A	N/A
Asbestos type:	N/A	N/A
Material Assessment Score:		N/A
Priority Assessment Score:		N/A
Action:	N/A	
Comments:	N/A	

Document Name	Author	Issued by	Revision Number	Issue Date	Page No
2019	Kacey Lillis	Armour AS	0	29/11/2019	18



Item No: 14

Sample No: N/A

Location: 99/001 External



Material Description:	Visual Inspection – No Suspect Materials Found	
Identification:	N/A	
Approx. quantity:	N/A	
Accessibility	N/A	Assessment Score
Product type:	N/A	N/A
Extent of Damage:	N/A	N/A
Surface Treatment:	N/A	N/A
Asbestos type:	N/A	N/A
Material Assessment Score:		N/A
Priority Assessment Score:		N/A
Action:	N/A	
Comments:	N/A	

Document Name	Author	Issued by	Revision Number	Issue Date	Page No
2019	Kacey Lillis	Armour AS	0	29/11/2019	19



## Section 6: Survey Objectives

Instructions were received from James Croucher of Lochailort Newbury Ltd to carry out a Management asbestos survey at Kennet Centre, Market Street, Newbury, Berkshire, RG14 5EN in accordance with HSG264 and Armour Analytical's quality procedures.

The survey was carried out on 28<sup>th</sup> October – 1<sup>st</sup> November 2019 by Neale Evans with the objective of facilitating a Management report.

This Management survey is characterised as a 'Visual Inspection Sampling and Identification Survey' in HSG264. This type of survey is used to locate and describe, so far as is reasonably practicable, all asbestos containing materials (ACMs) in the building and will by its nature involve the partial destruction of the building's fabric as access is gained to all areas. A full sampling programme is undertaken to identify possible ACMs and estimate the extent of ACMs reported.

The objective of this survey report is to identify, so far as is reasonably practicable, the location, extent, product type and composition of ACMS within the building to enable the building occupants to put management and remedial procedures in place.

Document Name	Author	Issued by	Revision Number	Issue Date	Page No
2019	Kacey Lillis	Armour AS	0	29/11/2019	20



## Section 7: Survey Techniques

Each floor, room and area within the scope was systematically inspected for suspect materials thought or known to contain asbestos and where such materials were encountered their location, extent, and composition were recorded.

Where materials of a similar nature exist, to those previously sampled, and a reasoned argument can be made that their composition is likely to be identical further physical sampling was not undertaken.

Photographs were taken of all sample locations, unless otherwise stated.

The analysis of suspect ACMs was undertaken by a UKAS accredited laboratory using the analytical method detailed in *HSG248, Appendix 2 -Asbestos: The analysts' guide for sampling, analysis and clearance procedures*.

Document Name	Author	Issued by	Revision Number	Issue Date	Page No
2019	Kacey Lillis	Armour AS	0	29/11/2019	21



## Section 8: Survey Caveat

This report is based upon a management report inspection of an unfamiliar site. During the course of the survey all reasonable efforts were made to identify the physical presence of materials containing asbestos within the building.

A Management Survey is a non-intrusive survey, meaning that access within the fabric of the building is limited. The survey does not include access to the following areas (unless agreed beforehand with the Client and provisions are put in place):

- Within wall or ceiling construction;
- Under fixed flooring;
- Within non-openable boxings;
- Within live electrics, boilers or machinery;
- Where access/visibility is limited in an area due to stored items, furniture or services;
- Areas where there is no safe access to inspect such as floor ducts, lift shafts and loft spaces with no crawlboards;
- High level areas that are too high to safely inspect.
- Within pipework insulation throughout building as this would affect the integrity of services.

Any intrusive works carried out within the building must first be subject to a Refurbishment Asbestos Survey.

This report will be restricted to the areas that fall within the scope of works for project and will **not take into account any area's that do not fall within the scope. Any asbestos that is identified** within this report will need to be added to the buildings existing information and should not form the basis for a management survey. This survey will not include priority assessments nor will it include a register.

This survey considered the construction of the building, associated fixtures & fittings and associated structures and in no way should it be considered as a ground investigation report.

Services should be disconnected prior to commencement of a Management survey; however, where plant and/or electrical installations are live or appear to be live then these will not be accessed.

This survey report is not a bill of quantities.

Document Name	Author	Issued by	Revision Number	Issue Date	Page No
2019	Kacey Lillis	Armour AS	0	29/11/2019	22

## Section 9: Survey Notes

This report has been written with reference to the various Guidance Notes etc, issued, and current at the date of this report and describes circumstances at the site on the date the investigation took place.

Where similar items exist in the building, only one or two samples have been taken to ascertain the material content. It was assumed that similar products were of the same material.

Any person undertaking work within the buildings should be told of the presence of asbestos. This briefing also applies to any other person associated with the site, including staff, sub-contractors and others.

The drawings in the report are not to scale and are illustrative only to indicate approximate locations. The descriptions used are for location identification purposes.

All the recommendations described in this report are based upon assumptions made after consideration of the type of material, condition of the material, its location, analysis result and type of use the area is thought to be subjected to. However, statutory authorities or others could require amendments based on local knowledge, change in legislation, change in use or indeed other conditions or criteria.

Samples taken from floor tiles (or similar material) may include a bitumen adhesive as part of the sample. It is known that some proprietary brands of bitumen have an asbestos content and this will be included as an integral part of the bulk sample unless otherwise stated.

Document Name	Author	Issued by	Revision Number	Issue Date	Page No
2019	Kacey Lillis	Armour AS	0	29/11/2019	23

## Section 10: Material Assessment Algorithm

Variable	Score	Examples
Installation / Product type	1	<b>Vinyl, 'Bakelite', Cement</b>
	2	Asbestos insulating board, paper, rope
	3	Pipe insulation, spray coating, friable debris
Condition / damage	0	Good
	1	Slight / minor damage
	2	Moderate damage – breakage to surface treatment
	3	Major damage – smashed or exposed material
Surface treatment	0	Non-friable e.g. vinyl
	1	Enclosed insulation, encapsulated AIB
	2	Unsealed AIB, encapsulated insulation
	3	Unsealed insulation or spray coating
Asbestos type	1	Chrysotile
	2	Amosite & other amphiboles
	3	Crocidolite

The scores from each of the four sections are added together to produce a risk score:

Risk score	Risk assessment
10 or more	High risk
7 – 9	Medium risk
5 – 6	Low risk
4 & below	Negligible risk

Document Name	Author	Issued by	Revision Number	Issue Date	Page No
2019	Kacey Lillis	Armour AS	0	29/11/2019	24



Section 11: Certificates of Bulk Analysis



Our Ref: J178824 FI: 2  
Your Ref: 3113  
Date: 06/11/2019

**ENVIROCHEM**  
Analytical Laboratories Ltd.  
12 The Gardens  
Broadcut, Fareham  
Hampshire  
PO16 8SS



Tel: (01329) 287777  
Fax: (01329) 287755  
www.envirochem.co.uk  
office@envirochem.co.uk

**Asbestos Fibre Identification Report**

**Client:** Armour Analytical Services Ltd  
Admirals Yard, Station Road, Patchway, Bristol, BS34 6LR  
**Site Address:** 143-145 Bartholomew Street,  
**Sampled By:** Armour Analytical Services Ltd  
**Date sampled/received:** 5th November 2019  
**Date analysed:** 6th November 2019  
**Analyst/s:** Stefan Kitchener  
**Analysis Location:** 12 The Gardens, Broadcut, Fareham, Hampshire, PO16 8SS

**ANALYTICAL PROCEDURE**

Fibre identification was carried out in accordance with the documented 'in-house' method (2.01) based on the HSE Guidance Note HSG 248. These employed stereo microscopy, polarized microscopy and dispersion staining techniques.

**RESULTS**

Sample No.	Sample Ref.	Location	Asbestos Detected	Asbestos Type
NE/1	BS584562	First Floor 003 WC - Vinyl floor tiles	No	
NE/2	BS584563	First Floor 005 Kitchen - Sink pad	Yes	Chrysotile

**NOTES:**

1. Sample(s) were examined for the presence of 6 types of asbestos fibres: crocidolite (blue), amosite (brown), chrysotile (white), anthrophyllite, actinolite and tremolite.
2. The results shown in this test report specifically refer to the sample(s) tested as received unless otherwise stated and samples collected by the client are evaluated using information provided by the client. For samples collected by the client the date of receipt is deemed to be the same as the date sampled.
3. Envirochem is a UKAS accredited laboratory for sampling and identification of asbestos containing materials.
4. Comments, observations and opinions are outside the scope of UKAS accreditation.
5. The analytical method in the HSG248 does not quantify the amount of asbestos present, therefore UKAS accreditation does not permit quantification.
6. If, during fibre identification, only 1 or 2 fibres are seen and identified as asbestos, then the term 'trace asbestos identified' is used.
7. This report shall not be reproduced except in full, without written approval of Envirochem.

SIGNATURE:

Authorised signatory





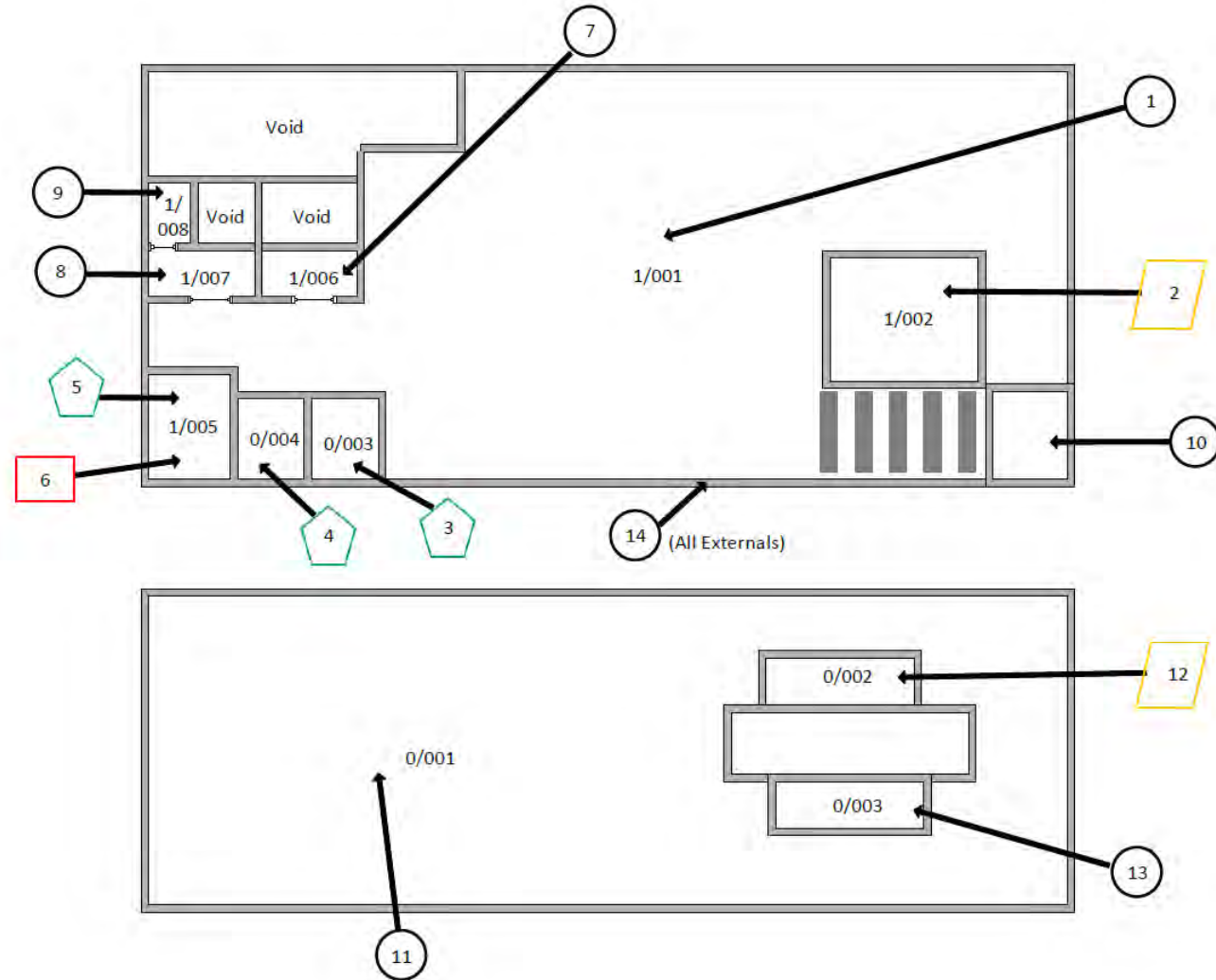

PRINT NAME: Stefan Kitchener

Reg. No. 2378228 England. Registered Office: Envirochem, 12 The Gardens, Broadcut, Fareham, Hampshire, PO16 8SS.

Document Name	Author	Issued by	Revision Number	Issue Date	Page No
2019	Kacey Lillis	Armour AS	0	29/11/2019	25

## Section 12: Site Plan



Key	
	Visual Inspection
	Asbestos Detected (Positive Item)
	No Asbestos Detected (Negative Item)
	Presumed to Contain Asbestos
	Strongly Presumed to Contain Asbestos
	No Access

Document Name	Author	Issued by	Revision Number	Issue Date	Page No
2019	Kacey Lillis	Armour AS	0	29/11/2019	26



I the surveyor can confirm that this report is accurate to my findings onsite and this survey has been Content checked by myself.

Checked by: Neale Evans

Date: 28.11.2019

I the Admin Manager can confirm that this report is accurate to the paperwork received and this survey has been quality checked by myself.

Checked by: Emma Humphreys

Date: 25.11.2019

Report Compiled By

Armour Analytical Services Ltd, Admirals Yard, Station Road, Bristol, BS34 6LR

Document Name	Author	Issued by	Revision Number	Issue Date	Page No
2019	Kacey Lillis	Armour AS	0	29/11/2019	27



**ENVIROCHEM**  
**Analytical Laboratories Ltd.**  
12 The Gardens  
Broadcut, Fareham  
Hampshire  
PO16 8SS



Our Ref: J178498 FI: 3  
Your Ref: 3113  
Date: 31/10/2019

Tel: (01329) 287777  
Fax: (01329) 287755  
www.envirochem.co.uk  
office@envirochem.co.uk

## Asbestos Fibre Identification Report

**Client:** Armour Analytical Services Ltd  
Admirals Yard, Station Road, Patchway, Bristol, BS34 6LR

**Site Address:** Kennet Centre Market Place, Newbury, 1-3 The Mall, RG14 5EN

**Sampled By:** Armour Analytical Services Ltd

**Date sampled/received:** 30th October 2019

**Date analysed:** 31st October 2019

**Analyst/s:** Matt Hurst

**Analysis Location:** 12 The Gardens, Broadcut, Fareham, Hampshire, PO16 8SS

### ANALYTICAL PROCEDURE

Fibre identification was carried out in accordance with the documented 'in-house' method (2.01) based on the HSE Guidance Note HSG 248. These employed stereo microscopy, polarized microscopy and dispersion staining techniques.

### RESULTS

Sample No.	Sample Ref.	Location	Asbestos Detected	Asbestos Type
NE/1	BS583490	1st Floor, 001 Store - Vinyl Floor Tiles	Yes	Chrysotile
NE/2	BS583491	1st Floor, 002 - Vinyl Floor Tiles	No	
NE/3	BS583492	1st Floor, 004 WC - Toilet Cistern	Yes	Amosite

NOTES:

1. Sample(s) were examined for the presence of 6 types of asbestos fibres: crocidolite (blue), amosite (brown), chrysotile (white), anthophyllite, actinolite and tremolite.
2. The results shown in this test report specifically refer to the sample(s) tested as received unless otherwise stated and samples collected by the client are evaluated using information provided by the client. For samples collected by the client the date of receipt is deemed to be the same as the date sampled.
3. Envirochem is a UKAS accredited laboratory for sampling and identification of asbestos containing materials.
4. Comments, observations and opinions are outside the scope of UKAS accreditation.
5. The analytical method in the HSG248 does not quantify the amount of asbestos present, therefore UKAS accreditation does not permit quantification.
6. If, during fibre identification, only 1 or 2 fibres are seen and identified as asbestos, then the term 'trace asbestos identified' is used.
7. This report shall not be reproduced except in full, without written approval of Envirochem.

SIGNATURE:  

Authorised signatory

PRINT NAME: Matt Hurst

Reg. No. 2378228 England. Registered Office: Envirochem, 12 The Gardens, Broadcut, Fareham, Hampshire, PO16 8SS.



**ENVIROCHEM**  
**Analytical Laboratories Ltd.**  
12 The Gardens  
Broadcut, Fareham  
Hampshire  
PO16 8SS



Our Ref: J178499 FI: 3  
Your Ref: 3113  
Date: 31/10/2019

Tel: (01329) 287777  
Fax: (01329) 287755  
www.envirochem.co.uk  
office@envirochem.co.uk

## Asbestos Fibre Identification Report

**Client:** Armour Analytical Services Ltd  
Admirals Yard, Station Road, Patchway, Bristol, BS34 6LR

**Site Address:** Kennet Centre Market Place, Newbury, 5 Market Place, RG14 5EN

**Sampled By:** Armour Analytical Services Ltd

**Date sampled/received:** 30th October 2019

**Date analysed:** 31st October 2019

**Analyst/s:** Matt Hurst

**Analysis Location:** 12 The Gardens, Broadcut, Fareham, Hampshire, PO16 8SS

### ANALYTICAL PROCEDURE

Fibre identification was carried out in accordance with the documented 'in-house' method (2.01) based on the HSE Guidance Note HSG 248. These employed stereo microscopy, polarized microscopy and dispersion staining techniques.

### RESULTS

Sample No.	Sample Ref.	Location	Asbestos Detected	Asbestos Type
NE/1	BS583493	1st Floor, 004 Kitchen - Vinyl Floor Tiles	No	
NE/2	BS583494	1st Floor, 007 - Vinyl Floor Tiles	No	
NE/3	BS583495	Ground Floor, 002 Cupboard - Vinyl Floor Tiles	No	

NOTES:

1. Sample(s) were examined for the presence of 6 types of asbestos fibres: crocidolite (blue), amosite (brown), chrysotile (white), anthophyllite, actinolite and tremolite.
2. The results shown in this test report specifically refer to the sample(s) tested as received unless otherwise stated and samples collected by the client are evaluated using information provided by the client. For samples collected by the client the date of receipt is deemed to be the same as the date sampled.
3. Envirochem is a UKAS accredited laboratory for sampling and identification of asbestos containing materials.
4. Comments, observations and opinions are outside the scope of UKAS accreditation.
5. The analytical method in the HSG248 does not quantify the amount of asbestos present, therefore UKAS accreditation does not permit quantification.
6. If, during fibre identification, only 1 or 2 fibres are seen and identified as asbestos, then the term 'trace asbestos identified' is used.
7. This report shall not be reproduced except in full, without written approval of Envirochem.

SIGNATURE:  

Authorised signatory

PRINT NAME: Matt Hurst

Reg. No. 2378228 England. Registered Office: Envirochem, 12 The Gardens, Broadcut, Fareham, Hampshire, PO16 8SS.





**ENVIROCHEM**  
**Analytical Laboratories Ltd.**  
12 The Gardens  
Broadcut, Fareham  
Hampshire  
PO16 8SS



Our Ref: J178821 FI: 2  
Your Ref: 3113  
Date: 06/11/2019

Tel: (01329) 287777  
Fax: (01329) 287755  
www.envirochem.co.uk  
office@envirochem.co.uk

## Asbestos Fibre Identification Report

**Client:** Armour Analytical Services Ltd  
Admirals Yard, Station Road, Patchway, Bristol, BS34 6LR

**Site Address:** 7 Market Place, Kennet Centre, Market Place, Newbury, RG14 5EN

**Sampled By:** Armour Analytical Services Ltd

**Date sampled/received:** 5th November 2019

**Date analysed:** 6th November 2019

**Analyst/s:** Stefan Kitchener

**Analysis Location:** 12 The Gardens, Broadcut, Fareham, Hampshire, PO16 8SS

### ANALYTICAL PROCEDURE

Fibre identification was carried out in accordance with the documented 'in-house' method (2.01) based on the HSE Guidance Note HSG 248. These employed stereo microscopy, polarized microscopy and dispersion staining techniques.

### RESULTS

Sample No.	Sample Ref.	Location	Asbestos Detected	Asbestos Type
NE/1	BS584556	Ground Floor, 002 WC - Textured coating to ceiling	No	
NE/2	BS584557	Ground Floor, 008 Kitchen - Bitumen sink pad	No	

#### NOTES:

1. Sample(s) were examined for the presence of 6 types of asbestos fibres: crocidolite (blue), amosite (brown), chrysotile (white), anthophyllite, actinolite and tremolite.
2. The results shown in this test report specifically refer to the sample(s) tested as received unless otherwise stated and samples collected by the client are evaluated using information provided by the client. For samples collected by the client the date of receipt is deemed to be the same as the date sampled.
3. Envirochem is a UKAS accredited laboratory for sampling and identification of asbestos containing materials.
4. Comments, observations and opinions are outside the scope of UKAS accreditation.
5. The analytical method in the HSG248 does not quantify the amount of asbestos present, therefore UKAS accreditation does not permit quantification.
6. If, during fibre identification, only 1 or 2 fibres are seen and identified as asbestos, then the term 'trace asbestos identified' is used.
7. This report shall not be reproduced except in full, without written approval of Envirochem.

SIGNATURE:

Authorised signatory

PRINT NAME: Stefan Kitchener

**Reg. No. 2378228 England. Registered Office: Envirochem, 12 The Gardens, Broadcut, Fareham, Hampshire, PO16 8SS.**



**ENVIROCHEM**  
**Analytical Laboratories Ltd.**  
12 The Gardens  
Broadcut, Fareham  
Hampshire  
PO16 8SS



Our Ref: J178811 FI: 4  
Your Ref: 3113  
Date: 06/11/2019

Tel: (01329) 287777  
Fax: (01329) 287755  
www.envirochem.co.uk  
office@envirochem.co.uk

## Asbestos Fibre Identification Report

**Client:** Armour Analytical Services Ltd  
Admirals Yard, Station Road, Patchway, Bristol, BS34 6LR

**Site Address:** 7-9 The Wall, Kennet Centre Market Place, Newbury, RG14 5EN

**Sampled By:** Armour Analytical Services Ltd

**Date sampled/received:** 5th November 2019

**Date analysed:** 6th November 2019

**Analyst/s:** Stefan Kitchener

**Analysis Location:** 12 The Gardens, Broadcut, Fareham, Hampshire, PO16 8SS

### ANALYTICAL PROCEDURE

Fibre identification was carried out in accordance with the documented 'in-house' method (2.01) based on the HSE Guidance Note HSG 248. These employed stereo microscopy, polarized microscopy and dispersion staining techniques.

### RESULTS

Sample No.	Sample Ref.	Location	Asbestos Detected	Asbestos Type
NE/1	BS584504	First Floor 001 Corridor - Vinyl floor tiles	No	
NE/2	BS584505	First Floor 006 Corridor - Vinyl floor tiles	No	
NE/3	BS584506	Ground Floor 001 Shop Floor - Sprayed coating	No	
NE/4	BS584507	Ground Floor 002 Lobby - Vinyl floor tiles	No	

#### NOTES:

1. Sample(s) were examined for the presence of 6 types of asbestos fibres: crocidolite (blue), amosite (brown), chrysotile (white), anthophyllite, actinolite and tremolite.
2. The results shown in this test report specifically refer to the sample(s) tested as received unless otherwise stated and samples collected by the client are evaluated using information provided by the client. For samples collected by the client the date of receipt is deemed to be the same as the date sampled.
3. Envirochem is a UKAS accredited laboratory for sampling and identification of asbestos containing materials.
4. Comments, observations and opinions are outside the scope of UKAS accreditation.
5. The analytical method in the HSG248 does not quantify the amount of asbestos present, therefore UKAS accreditation does not permit quantification.
6. If, during fibre identification, only 1 or 2 fibres are seen and identified as asbestos, then the term 'trace asbestos identified' is used.
7. This report shall not be reproduced except in full, without written approval of Envirochem.

SIGNATURE:

Authorised signatory

PRINT NAME: Stefan Kitchener

**Reg. No. 2378228 England. Registered Office: Envirochem, 12 The Gardens, Broadcut, Fareham, Hampshire, PO16 8SS.**



**ENVIROCHEM**  
**Analytical Laboratories Ltd.**  
12 The Gardens  
Broadcut, Fareham  
Hampshire  
PO16 8SS



Our Ref: J178488 Rev. 2 FI: 4  
Your Ref: 3113  
Date: 01/11/2019

Tel: (01329) 287777  
Fax: (01329) 287755  
www.envirochem.co.uk  
office@envirochem.co.uk

## Asbestos Fibre Identification Report

**Client:** Armour Analytical Services Ltd  
Admirals Yard, Station Road, Patchway, Bristol, BS34 6LR

**Site Address:** 11 the Mall, Kennet Centre Market Place, Newbury, RG14 5EN

**Sampled By:** Armour Analytical Services Ltd

**Date sampled/received:** 30th October 2019

**Date analysed:** 31st October 2019

**Analyst/s:** Matt Hurst

**Analysis Location:** 12 The Gardens, Broadcut, Fareham, Hampshire, PO16 8SS

### ANALYTICAL PROCEDURE

Fibre identification was carried out in accordance with the documented 'in-house' method (2.01) based on the HSE Guidance Note HSG 248. These employed stereo microscopy, polarized microscopy and dispersion staining techniques.

### RESULTS

Sample No.	Sample Ref.	Location	Asbestos Detected	Asbestos Type
NE/1	BS583443	1st Floor, 001 Store - Vinyl Floor Tiles	Yes	Chrysotile
NE/2	BS583444	1st Floor, 002 Corridor - Bitumen Adhesive	Yes	Chrysotile
NE/3	BS583445	1st Floor, 004 WC - Toilet Cistern	Yes	Amosite
NE/4	BS583446	Ground Floor, 004 - Vinyl Floor Tiles	No	

#### NOTES:

1. Sample(s) were examined for the presence of 6 types of asbestos fibres: crocidolite (blue), amosite (brown), chrysotile (white), anthophyllite, actinolite and tremolite.
2. The results shown in this test report specifically refer to the sample(s) tested as received unless otherwise stated and samples collected by the client are evaluated using information provided by the client. For samples collected by the client the date of receipt is deemed to be the same as the date sampled.
3. Envirochem is a UKAS accredited laboratory for sampling and identification of asbestos containing materials.
4. Comments, observations and opinions are outside the scope of UKAS accreditation.
5. The analytical method in the HSG248 does not quantify the amount of asbestos present, therefore UKAS accreditation does not permit quantification.
6. If, during fibre identification, only 1 or 2 fibres are seen and identified as asbestos, then the term 'trace asbestos identified' is used.
7. This report shall not be reproduced except in full, without written approval of Envirochem.

SIGNATURE:

Authorised signatory

PRINT NAME: Frances Scott

**Reg. No. 2378228 England. Registered Office: Envirochem, 12 The Gardens, Broadcut, Fareham, Hampshire, PO16 8SS.**



**ENVIROCHEM**  
**Analytical Laboratories Ltd.**  
12 The Gardens  
Broadcut, Fareham  
Hampshire  
PO16 8SS



Our Ref: J178826 FI: 1  
Your Ref: 3113  
Date: 06/11/2019

Tel: (01329) 287777  
Fax: (01329) 287755  
www.envirochem.co.uk  
office@envirochem.co.uk

## Asbestos Fibre Identification Report

**Client:** Armour Analytical Services Ltd  
Admirals Yard, Station Road, Patchway, Bristol, BS34 6LR

**Site Address:** 12 The Mall, Kennet Centre, Market Place Newbury, RG14 5EN

**Sampled By:** Armour Analytical Services Ltd

**Date sampled/received:** 5th November 2019

**Date analysed:** 6th November 2019

**Analyst/s:** Stefan Kitchener

**Analysis Location:** 12 The Gardens, Broadcut, Fareham, Hampshire, PO16 8SS

### ANALYTICAL PROCEDURE

Fibre identification was carried out in accordance with the documented 'in-house' method (2.01) based on the HSE Guidance Note HSG 248. These employed stereo microscopy, polarized microscopy and dispersion staining techniques.

### RESULTS

Sample No.	Sample Ref.	Location	Asbestos Detected	Asbestos Type
NE/1	BS584565	Ground Floor 001 - Vinyl floor tiles	No	

#### NOTES:

1. Sample(s) were examined for the presence of 6 types of asbestos fibres: crocidolite (blue), amosite (brown), chrysotile (white), anthophyllite, actinolite and tremolite.
2. The results shown in this test report specifically refer to the sample(s) tested as received unless otherwise stated and samples collected by the client are evaluated using information provided by the client. For samples collected by the client the date of receipt is deemed to be the same as the date sampled.
3. Envirochem is a UKAS accredited laboratory for sampling and identification of asbestos containing materials.
4. Comments, observations and opinions are outside the scope of UKAS accreditation.
5. The analytical method in the HSG248 does not quantify the amount of asbestos present, therefore UKAS accreditation does not permit quantification.
6. If, during fibre identification, only 1 or 2 fibres are seen and identified as asbestos, then the term 'trace asbestos identified' is used.
7. This report shall not be reproduced except in full, without written approval of Envirochem.

SIGNATURE:

Authorised signatory

PRINT NAME: Stefan Kitchener

**Reg. No. 2378228 England. Registered Office: Envirochem, 12 The Gardens, Broadcut, Fareham, Hampshire, PO16 8SS.**



**ENVIROCHEM**  
**Analytical Laboratories Ltd.**  
12 The Gardens  
Broadcut, Fareham  
Hampshire  
PO16 8SS



Our Ref: J178496 FI: 4  
Your Ref: 3113  
Date: 31/10/2019

Tel: (01329) 287777  
Fax: (01329) 287755  
www.envirochem.co.uk  
office@envirochem.co.uk

## Asbestos Fibre Identification Report

**Client:** Armour Analytical Services Ltd  
Admirals Yard, Station Road, Patchway, Bristol, BS34 6LR

**Site Address:** Kennet Centre Market Centre, Newbury, 16 The Mall, RG14 5EN

**Sampled By:** Armour Analytical Services Ltd

**Date sampled/received:** 30th October 2019

**Date analysed:** 31st October 2019

**Analyst/s:** Matt Hurst

**Analysis Location:** 12 The Gardens, Broadcut, Fareham, Hampshire, PO16 8SS

### ANALYTICAL PROCEDURE

Fibre identification was carried out in accordance with the documented 'in-house' method (2.01) based on the HSE Guidance Note HSG 248. These employed stereo microscopy, polarized microscopy and dispersion staining techniques.

### RESULTS

Sample No.	Sample Ref.	Location	Asbestos Detected	Asbestos Type
NE/1	BS583471	1st Floor, 002 WC - Toilet Cistern	Yes	Amosite
NE/2	BS583472	1st Floor, 003 Stairs - Vinyl Floor Tiles	Yes	Chrysotile
NE/3	BS583473	Ground Floor, 001 Shop Floor - Insulation Board	No	
NE/4	BS583474	Ground Floor, 002 Store - Vinyl Floor Tiles	Yes	Chrysotile

#### NOTES:

1. Sample(s) were examined for the presence of 6 types of asbestos fibres: crocidolite (blue), amosite (brown), chrysotile (white), anthophyllite, actinolite and tremolite.
2. The results shown in this test report specifically refer to the sample(s) tested as received unless otherwise stated and samples collected by the client are evaluated using information provided by the client. For samples collected by the client the date of receipt is deemed to be the same as the date sampled.
3. Envirochem is a UKAS accredited laboratory for sampling and identification of asbestos containing materials.
4. Comments, observations and opinions are outside the scope of UKAS accreditation.
5. The analytical method in the HSG248 does not quantify the amount of asbestos present, therefore UKAS accreditation does not permit quantification.
6. If, during fibre identification, only 1 or 2 fibres are seen and identified as asbestos, then the term 'trace asbestos identified' is used.
7. This report shall not be reproduced except in full, without written approval of Envirochem.

SIGNATURE:  

Authorised signatory

PRINT NAME: Matt Hurst

Reg. No. 2378228 England. Registered Office: Envirochem, 12 The Gardens, Broadcut, Fareham, Hampshire, PO16 8SS.



**ENVIROCHEM**  
**Analytical Laboratories Ltd.**  
12 The Gardens  
Broadcut, Fareham  
Hampshire  
PO16 8SS



Our Ref: J178835 FI: 1  
Your Ref: 3113  
Date: 06/11/2019

Tel: (01329) 287777  
Fax: (01329) 287755  
www.envirochem.co.uk  
office@envirochem.co.uk

## Asbestos Fibre Identification Report

**Client:** Armour Analytical Services Ltd  
Admirals Yard, Station Road, Patchway, Bristol, BS34 6LR

**Site Address:** 22 The Mall, Kennet Centre Market Place, Newbury, RG14 5EN

**Sampled By:** Armour Analytical Services Ltd

**Date sampled/received:** 5th November 2019

**Date analysed:** 6th November 2019

**Analyst/s:** Stefan Kitchener

**Analysis Location:** 12 The Gardens, Broadcut, Fareham, Hampshire, PO16 8SS

### ANALYTICAL PROCEDURE

Fibre identification was carried out in accordance with the documented 'in-house' method (2.01) based on the HSE Guidance Note HSG 248. These employed stereo microscopy, polarized microscopy and dispersion staining techniques.

### RESULTS

Sample No.	Sample Ref.	Location	Asbestos Detected	Asbestos Type
NE/1	BS584577	First Floor Store 001 - Vinyl floor sheets	No	

NOTES:

1. Sample(s) were examined for the presence of 6 types of asbestos fibres: crocidolite (blue), amosite (brown), chrysotile (white), anthophyllite, actinolite and tremolite.
2. The results shown in this test report specifically refer to the sample(s) tested as received unless otherwise stated and samples collected by the client are evaluated using information provided by the client. For samples collected by the client the date of receipt is deemed to be the same as the date sampled.
3. Envirochem is a UKAS accredited laboratory for sampling and identification of asbestos containing materials.
4. Comments, observations and opinions are outside the scope of UKAS accreditation.
5. The analytical method in the HSG248 does not quantify the amount of asbestos present, therefore UKAS accreditation does not permit quantification.
6. If, during fibre identification, only 1 or 2 fibres are seen and identified as asbestos, then the term 'trace asbestos identified' is used.
7. This report shall not be reproduced except in full, without written approval of Envirochem.

SIGNATURE:

Authorised signatory

PRINT NAME: Stefan Kitchener

**Reg. No. 2378228 England. Registered Office: Envirochem, 12 The Gardens, Broadcut, Fareham, Hampshire, PO16 8SS.**



**ENVIROCHEM**  
**Analytical Laboratories Ltd.**  
12 The Gardens  
Broadcut, Fareham  
Hampshire  
PO16 8SS



Our Ref: J178832 FI: 2  
Your Ref: 3113  
Date: 06/11/2019

Tel: (01329) 287777  
Fax: (01329) 287755  
www.envirochem.co.uk  
office@envirochem.co.uk

## Asbestos Fibre Identification Report

**Client:** Armour Analytical Services Ltd  
Admirals Yard, Station Road, Patchway, Bristol, BS34 6LR

**Site Address:** 23 The Mall, Kennet Centre, Market Place, Newbury, RG14 5EN

**Sampled By:** Armour Analytical Services Ltd

**Date sampled/received:** 5th November 2019

**Date analysed:** 6th November 2019

**Analyst/s:** Stefan Kitchener

**Analysis Location:** 12 The Gardens, Broadcut, Fareham, Hampshire, PO16 8SS

### ANALYTICAL PROCEDURE

Fibre identification was carried out in accordance with the documented 'in-house' method (2.01) based on the HSE Guidance Note HSG 248. These employed stereo microscopy, polarized microscopy and dispersion staining techniques.

### RESULTS

Sample No.	Sample Ref.	Location	Asbestos Detected	Asbestos Type
NE/1	BS584575	First Floor, 001 Store - Vinyl floor tiles	No	
NE/2	BS584576	First Floor, 002 Kitchen - Sink pad	No	

#### NOTES:

1. Sample(s) were examined for the presence of 6 types of asbestos fibres: crocidolite (blue), amosite (brown), chrysotile (white), anthophyllite, actinolite and tremolite.
2. The results shown in this test report specifically refer to the sample(s) tested as received unless otherwise stated and samples collected by the client are evaluated using information provided by the client. For samples collected by the client the date of receipt is deemed to be the same as the date sampled.
3. Envirochem is a UKAS accredited laboratory for sampling and identification of asbestos containing materials.
4. Comments, observations and opinions are outside the scope of UKAS accreditation.
5. The analytical method in the HSG248 does not quantify the amount of asbestos present, therefore UKAS accreditation does not permit quantification.
6. If, during fibre identification, only 1 or 2 fibres are seen and identified as asbestos, then the term 'trace asbestos identified' is used.
7. This report shall not be reproduced except in full, without written approval of Envirochem.

SIGNATURE:

Authorised signatory

PRINT NAME: Stefan Kitchener

**Reg. No. 2378228 England. Registered Office: Envirochem, 12 The Gardens, Broadcut, Fareham, Hampshire, PO16 8SS.**



**ENVIROCHEM**  
**Analytical Laboratories Ltd.**  
12 The Gardens  
Broadcut, Fareham  
Hampshire  
PO16 8SS



Our Ref: J178495 FI: 12  
Your Ref: 3113  
Date: 31/10/2019

Tel: (01329) 287777  
Fax: (01329) 287755  
www.envirochem.co.uk  
office@envirochem.co.uk

## Asbestos Fibre Identification Report

**Client:** Armour Analytical Services Ltd  
Admirals Yard, Station Road, Patchway, Bristol, BS34 6LR

**Site Address:** Kennet Centre Market Place, Newbury, 24 Cheap Street, RG14 5EN

**Sampled By:** Armour Analytical Services Ltd

**Date sampled/received:** 30th October 2019

**Date analysed:** 31st October 2019

**Analyst/s:** Matt Hurst

**Analysis Location:** 12 The Gardens, Broadcut, Fareham, Hampshire, PO16 8SS

### ANALYTICAL PROCEDURE

Fibre identification was carried out in accordance with the documented 'in-house' method (2.01) based on the HSE Guidance Note HSG 248. These employed stereo microscopy, polarized microscopy and dispersion staining techniques.

### RESULTS

Sample No.	Sample Ref.	Location	Asbestos Detected	Asbestos Type
NE/1	BS583459	3rd Floor, 002 Lift Motor Room - Lift Break Shoes	No	
NE/2	BS583460	3rd Floor, 002 Lift Motor Room - Insulation Board	No	
NE/3	BS583461	2nd Floor, 003 - Insulation Board to Door	No	
NE/4	BS583462	2nd Floor, 001 Stairs - Vinyl Floor Tiles	Yes	Chrysotile

#### NOTES:

1. Sample(s) were examined for the presence of 6 types of asbestos fibres: crocidolite (blue), amosite (brown), chrysotile (white), anthophyllite, actinolite and tremolite.
2. The results shown in this test report specifically refer to the sample(s) tested as received unless otherwise stated and samples collected by the client are evaluated using information provided by the client. For samples collected by the client the date of receipt is deemed to be the same as the date sampled.
3. Envirochem is a UKAS accredited laboratory for sampling and identification of asbestos containing materials.
4. Comments, observations and opinions are outside the scope of UKAS accreditation.
5. The analytical method in the HSG248 does not quantify the amount of asbestos present, therefore UKAS accreditation does not permit quantification.
6. If, during fibre identification, only 1 or 2 fibres are seen and identified as asbestos, then the term 'trace asbestos identified' is used.
7. This report shall not be reproduced except in full, without written approval of Envirochem.

SIGNATURE:

Authorised signatory

PRINT NAME: Frances Scott

**Reg. No. 2378228 England. Registered Office: Envirochem, 12 The Gardens, Broadcut, Fareham, Hampshire, PO16 8SS.**





# ENVIROCHEM

Analytical Laboratories Ltd.  
12 The Gardens  
Broadcut, Fareham  
Hampshire  
PO16 8SS



Our Ref: J178495 FI: 12  
Your Ref: 3113  
Date: 31/10/2019

Tel: (01329) 287777  
Fax: (01329) 287755  
www.envirochem.co.uk  
office@envirochem.co.uk

## Asbestos Fibre Identification Report

**Client:** Armour Analytical Services Ltd  
Admirals Yard, Station Road, Patchway, Bristol, BS34 6LR

**Site Address:** Kennet Centre Market Place, Newbury, 24 Cheap Street, RG14 5EN

**Sampled By:** Armour Analytical Services Ltd

**Date sampled/received:** 30th October 2019

**Date analysed:** 31st October 2019

**Analyst/s:** Matt Hurst

**Analysis Location:** 12 The Gardens, Broadcut, Fareham, Hampshire, PO16 8SS

### ANALYTICAL PROCEDURE

Fibre identification was carried out in accordance with the documented 'in-house' method (2.01) based on the HSE Guidance Note HSG 248. These employed stereo microscopy, polarized microscopy and dispersion staining techniques.

### RESULTS

Sample No.	Sample Ref.	Location	Asbestos Detected	Asbestos Type
NE/5	BS583463	2nd Floor, 004 Corridor - Vinyl Floor Tiles	Yes	Chrysotile
NE/6	BS583464	2nd Floor, 013 Boiler Room - Insulation Board to Walls	Yes	Amosite
NE/7	BS583465	2nd Floor, 013 Boiler Room - Insulation Board to Floor	Yes	Amosite
NE/8	BS583466	2nd Floor, 014 Offices - Vinyl Floor Tiles	Yes	Chrysotile

#### NOTES:

1. Sample(s) were examined for the presence of 6 types of asbestos fibres: crocidolite (blue), amosite (brown), chrysotile (white), anthophyllite, actinolite and tremolite.
2. The results shown in this test report specifically refer to the sample(s) tested as received unless otherwise stated and samples collected by the client are evaluated using information provided by the client. For samples collected by the client the date of receipt is deemed to be the same as the date sampled.
3. Envirochem is a UKAS accredited laboratory for sampling and identification of asbestos containing materials.
4. Comments, observations and opinions are outside the scope of UKAS accreditation.
5. The analytical method in the HSG248 does not quantify the amount of asbestos present, therefore UKAS accreditation does not permit quantification.
6. If, during fibre identification, only 1 or 2 fibres are seen and identified as asbestos, then the term 'trace asbestos identified' is used.
7. This report shall not be reproduced except in full, without written approval of Envirochem.

SIGNATURE:

Authorised signatory

PRINT NAME: Frances Scott

Reg. No. 2378228 England. Registered Office: Envirochem, 12 The Gardens, Broadcut, Fareham, Hampshire, PO16 8SS.



**ENVIROCHEM**  
**Analytical Laboratories Ltd.**  
12 The Gardens  
Broadcut, Fareham  
Hampshire  
PO16 8SS



Our Ref: J178495 FI: 12  
Your Ref: 3113  
Date: 31/10/2019

Tel: (01329) 287777  
Fax: (01329) 287755  
www.envirochem.co.uk  
office@envirochem.co.uk

## Asbestos Fibre Identification Report

**Client:** Armour Analytical Services Ltd  
Admirals Yard, Station Road, Patchway, Bristol, BS34 6LR

**Site Address:** Kennet Centre Market Place, Newbury, 24 Cheap Street, RG14 5EN

**Sampled By:** Armour Analytical Services Ltd

**Date sampled/received:** 30th October 2019

**Date analysed:** 31st October 2019

**Analyst/s:** Matt Hurst

**Analysis Location:** 12 The Gardens, Broadcut, Fareham, Hampshire, PO16 8SS

### ANALYTICAL PROCEDURE

Fibre identification was carried out in accordance with the documented 'in-house' method (2.01) based on the HSE Guidance Note HSG 248. These employed stereo microscopy, polarized microscopy and dispersion staining techniques.

### RESULTS

Sample No.	Sample Ref.	Location	Asbestos Detected	Asbestos Type
NE/9	BS583467	2nd Floor, 020 - Vinyl Floor Tiles	Yes	Chrysotile
NE/10	BS583468	2nd Floor, 004 Corridor - Black Skirting Boards	No	
NE/11	BS583469	Ground Floor, 003 Electrics - Insulation Board to Doors	No	
NE/12	BS583470	Ground Floor, 003 Electrics - Fuse Flash guards	Yes	Chrysotile

#### NOTES:

1. Sample(s) were examined for the presence of 6 types of asbestos fibres: crocidolite (blue), amosite (brown), chrysotile (white), anthophyllite, actinolite and tremolite.
2. The results shown in this test report specifically refer to the sample(s) tested as received unless otherwise stated and samples collected by the client are evaluated using information provided by the client. For samples collected by the client the date of receipt is deemed to be the same as the date sampled.
3. Envirochem is a UKAS accredited laboratory for sampling and identification of asbestos containing materials.
4. Comments, observations and opinions are outside the scope of UKAS accreditation.
5. The analytical method in the HSG248 does not quantify the amount of asbestos present, therefore UKAS accreditation does not permit quantification.
6. If, during fibre identification, only 1 or 2 fibres are seen and identified as asbestos, then the term 'trace asbestos identified' is used.
7. This report shall not be reproduced except in full, without written approval of Envirochem.

SIGNATURE:

Authorised signatory

PRINT NAME: Frances Scott

**Reg. No. 2378228 England. Registered Office: Envirochem, 12 The Gardens, Broadcut, Fareham, Hampshire, PO16 8SS.**



**ENVIROCHEM**  
**Analytical Laboratories Ltd.**  
12 The Gardens  
Broadcut, Fareham  
Hampshire  
PO16 8SS



Our Ref: J178829 FI: 1  
Your Ref: 3113  
Date: 06/11/2019

Tel: (01329) 287777  
Fax: (01329) 287755  
www.envirochem.co.uk  
office@envirochem.co.uk

## Asbestos Fibre Identification Report

**Client:** Armour Analytical Services Ltd  
Admirals Yard, Station Road, Patchway, Bristol, BS34 6LR

**Site Address:** 24 The Mall, Kennet Centre Market Place, Newbury, RG14 5EN

**Sampled By:** Armour Analytical Services Ltd

**Date sampled/received:** 5th November 2019

**Date analysed:** 6th November 2019

**Analyst/s:** Stefan Kitchener

**Analysis Location:** 12 The Gardens, Broadcut, Fareham, Hampshire, PO16 8SS

### ANALYTICAL PROCEDURE

Fibre identification was carried out in accordance with the documented 'in-house' method (2.01) based on the HSE Guidance Note HSG 248. These employed stereo microscopy, polarized microscopy and dispersion staining techniques.

### RESULTS

Sample No.	Sample Ref.	Location	Asbestos Detected	Asbestos Type
NE/1	BS584567	First Floor 001 Store, Vinyl floor tiles	No	

NOTES:

1. Sample(s) were examined for the presence of 6 types of asbestos fibres: crocidolite (blue), amosite (brown), chrysotile (white), anthophyllite, actinolite and tremolite.
2. The results shown in this test report specifically refer to the sample(s) tested as received unless otherwise stated and samples collected by the client are evaluated using information provided by the client. For samples collected by the client the date of receipt is deemed to be the same as the date sampled.
3. Envirochem is a UKAS accredited laboratory for sampling and identification of asbestos containing materials.
4. Comments, observations and opinions are outside the scope of UKAS accreditation.
5. The analytical method in the HSG248 does not quantify the amount of asbestos present, therefore UKAS accreditation does not permit quantification.
6. If, during fibre identification, only 1 or 2 fibres are seen and identified as asbestos, then the term 'trace asbestos identified' is used.
7. This report shall not be reproduced except in full, without written approval of Envirochem.

SIGNATURE:

Authorised signatory

PRINT NAME: Stefan Kitchener

**Reg. No. 2378228 England. Registered Office: Envirochem, 12 The Gardens, Broadcut, Fareham, Hampshire, PO16 8SS.**



**ENVIROCHEM**  
**Analytical Laboratories Ltd.**  
12 The Gardens  
Broadcut, Fareham  
Hampshire  
PO16 8SS



Our Ref: J178823 FI: 2  
Your Ref: 3113  
Date: 06/11/2019

Tel: (01329) 287777  
Fax: (01329) 287755  
www.envirochem.co.uk  
office@envirochem.co.uk

## Asbestos Fibre Identification Report

**Client:** Armour Analytical Services Ltd  
Admirals Yard, Station Road, Patchway, Bristol, BS34 6LR

**Site Address:** 25 The Mall, Kennet Centre, Market Place, Newbury, RG14 5EN

**Sampled By:** Armour Analytical Services Ltd

**Date sampled/received:** 5th November 2019

**Date analysed:** 6th November 2019

**Analyst/s:** Stefan Kitchener

**Analysis Location:** 12 The Gardens, Broadcut, Fareham, Hampshire, PO16 8SS

### ANALYTICAL PROCEDURE

Fibre identification was carried out in accordance with the documented 'in-house' method (2.01) based on the HSE Guidance Note HSG 248. These employed stereo microscopy, polarized microscopy and dispersion staining techniques.

### RESULTS

Sample No.	Sample Ref.	Location	Asbestos Detected	Asbestos Type
NE/1	BS584560	First Floor 001 Stairs - Vinyl floor tiles	No	
NE/2	BS584561	Ground Floor 001 Store - Vinyl floor tiles	No	

#### NOTES:

1. Sample(s) were examined for the presence of 6 types of asbestos fibres: crocidolite (blue), amosite (brown), chrysotile (white), anthophyllite, actinolite and tremolite.
2. The results shown in this test report specifically refer to the sample(s) tested as received unless otherwise stated and samples collected by the client are evaluated using information provided by the client. For samples collected by the client the date of receipt is deemed to be the same as the date sampled.
3. Envirochem is a UKAS accredited laboratory for sampling and identification of asbestos containing materials.
4. Comments, observations and opinions are outside the scope of UKAS accreditation.
5. The analytical method in the HSG248 does not quantify the amount of asbestos present, therefore UKAS accreditation does not permit quantification.
6. If, during fibre identification, only 1 or 2 fibres are seen and identified as asbestos, then the term 'trace asbestos identified' is used.
7. This report shall not be reproduced except in full, without written approval of Envirochem.

SIGNATURE:

Authorised signatory

PRINT NAME: Stefan Kitchener

**Reg. No. 2378228 England. Registered Office: Envirochem, 12 The Gardens, Broadcut, Fareham, Hampshire, PO16 8SS.**



**ENVIROCHEM**  
**Analytical Laboratories Ltd.**  
12 The Gardens  
Broadcut, Fareham  
Hampshire  
PO16 8SS



Our Ref: J178497 FI: 1  
Your Ref: 3113  
Date: 31/10/2019

Tel: (01329) 287777  
Fax: (01329) 287755  
www.envirochem.co.uk  
office@envirochem.co.uk

## Asbestos Fibre Identification Report

**Client:** Armour Analytical Services Ltd  
Admirals Yard, Station Road, Patchway, Bristol, BS34 6LR

**Site Address:** Kennet Centre Market Place, Newbury, 26 The Mall, RG14 5EN

**Sampled By:** Armour Analytical Services Ltd

**Date sampled/received:** 30th October 2019

**Date analysed:** 31st October 2019

**Analyst/s:** Matt Hurst

**Analysis Location:** 12 The Gardens, Broadcut, Fareham, Hampshire, PO16 8SS

### ANALYTICAL PROCEDURE

Fibre identification was carried out in accordance with the documented 'in-house' method (2.01) based on the HSE Guidance Note HSG 248. These employed stereo microscopy, polarized microscopy and dispersion staining techniques.

### RESULTS

Sample No.	Sample Ref.	Location	Asbestos Detected	Asbestos Type
NE/1	BS583489	1st Floor, 002 Kitchen - Vinyl Floor Tiles	Yes	Chrysotile

NOTES:

1. Sample(s) were examined for the presence of 6 types of asbestos fibres: crocidolite (blue), amosite (brown), chrysotile (white), anthophyllite, actinolite and tremolite.
2. The results shown in this test report specifically refer to the sample(s) tested as received unless otherwise stated and samples collected by the client are evaluated using information provided by the client. For samples collected by the client the date of receipt is deemed to be the same as the date sampled.
3. Envirochem is a UKAS accredited laboratory for sampling and identification of asbestos containing materials.
4. Comments, observations and opinions are outside the scope of UKAS accreditation.
5. The analytical method in the HSG248 does not quantify the amount of asbestos present, therefore UKAS accreditation does not permit quantification.
6. If, during fibre identification, only 1 or 2 fibres are seen and identified as asbestos, then the term 'trace asbestos identified' is used.
7. This report shall not be reproduced except in full, without written approval of Envirochem.

SIGNATURE:  

Authorised signatory

PRINT NAME: Matt Hurst

Reg. No. 2378228 England. Registered Office: Envirochem, 12 The Gardens, Broadcut, Fareham, Hampshire, PO16 8SS.



**ENVIROCHEM**  
**Analytical Laboratories Ltd.**  
12 The Gardens  
Broadcut, Fareham  
Hampshire  
PO16 8SS



Our Ref: J178493 FI: 4  
Your Ref: 3113  
Date: 31/10/2019

Tel: (01329) 287777  
Fax: (01329) 287755  
www.envirochem.co.uk  
office@envirochem.co.uk

## Asbestos Fibre Identification Report

**Client:** Armour Analytical Services Ltd  
Admirals Yard, Station Road, Patchway, Bristol, BS34 6LR

**Site Address:** Kennet Centre Market Street, Newbury, 26-27 Cheap Street, RG14 5EN

**Sampled By:** Armour Analytical Services Ltd

**Date sampled/received:** 30th October 2019

**Date analysed:** 31st October 2019

**Analyst/s:** Matt Hurst

**Analysis Location:** 12 The Gardens, Broadcut, Fareham, Hampshire, PO16 8SS

### ANALYTICAL PROCEDURE

Fibre identification was carried out in accordance with the documented 'in-house' method (2.01) based on the HSE Guidance Note HSG 248. These employed stereo microscopy, polarized microscopy and dispersion staining techniques.

### RESULTS

Sample No.	Sample Ref.	Location	Asbestos Detected	Asbestos Type
1	BS583454	1st Floor, 001 WC - Toilet Cistern	Yes	Amosite
2	BS583455	1st Floor, 002 Kitchen - Vinyl Floor Tiles	Yes	Chrysotile
3	BS583456	1st Floor, 015 - Vinyl Floor Tiles	No	
4	BS583457	1st Floor, 012 Corridor - Vinyl Floor Tiles	No	

#### NOTES:

1. Sample(s) were examined for the presence of 6 types of asbestos fibres: crocidolite (blue), amosite (brown), chrysotile (white), anthophyllite, actinolite and tremolite.
2. The results shown in this test report specifically refer to the sample(s) tested as received unless otherwise stated and samples collected by the client are evaluated using information provided by the client. For samples collected by the client the date of receipt is deemed to be the same as the date sampled.
3. Envirochem is a UKAS accredited laboratory for sampling and identification of asbestos containing materials.
4. Comments, observations and opinions are outside the scope of UKAS accreditation.
5. The analytical method in the HSG248 does not quantify the amount of asbestos present, therefore UKAS accreditation does not permit quantification.
6. If, during fibre identification, only 1 or 2 fibres are seen and identified as asbestos, then the term 'trace asbestos identified' is used.
7. This report shall not be reproduced except in full, without written approval of Envirochem.

SIGNATURE:  

Authorised signatory

PRINT NAME: Matt Hurst

Reg. No. 2378228 England. Registered Office: Envirochem, 12 The Gardens, Broadcut, Fareham, Hampshire, PO16 8SS.



**ENVIROCHEM**  
**Analytical Laboratories Ltd.**  
12 The Gardens  
Broadcut, Fareham  
Hampshire  
PO16 8SS



Our Ref: J178808 FI: 2  
Your Ref: 3113  
Date: 06/11/2019

Tel: (01329) 287777  
Fax: (01329) 287755  
www.envirochem.co.uk  
office@envirochem.co.uk

## Asbestos Fibre Identification Report

**Client:** Armour Analytical Services Ltd  
Admirals Yard, Station Road, Patchway, Bristol, BS34 6LR

**Site Address:** 28 The Mall, Kennet Centre, Market Place, Newbury, RG14 5EN

**Sampled By:** Armour Analytical Services Ltd

**Date sampled/received:** 5th November 2019

**Date analysed:** 6th November 2019

**Analyst/s:** Stefan Kitchener

**Analysis Location:** 12 The Gardens, Broadcut, Fareham, Hampshire, PO16 8SS

### ANALYTICAL PROCEDURE

Fibre identification was carried out in accordance with the documented 'in-house' method (2.01) based on the HSE Guidance Note HSG 248. These employed stereo microscopy, polarized microscopy and dispersion staining techniques.

### RESULTS

Sample No.	Sample Ref.	Location	Asbestos Detected	Asbestos Type
NE/1	BS584500	First Floor, Shoe Store - Vinyl floor tiles	No	
NE/2	BS584501	Ground Floor, Shop Floor - Sprayed coating	No	

#### NOTES:

1. Sample(s) were examined for the presence of 6 types of asbestos fibres: crocidolite (blue), amosite (brown), chrysotile (white), anthophyllite, actinolite and tremolite.
2. The results shown in this test report specifically refer to the sample(s) tested as received unless otherwise stated and samples collected by the client are evaluated using information provided by the client. For samples collected by the client the date of receipt is deemed to be the same as the date sampled.
3. Envirochem is a UKAS accredited laboratory for sampling and identification of asbestos containing materials.
4. Comments, observations and opinions are outside the scope of UKAS accreditation.
5. The analytical method in the HSG248 does not quantify the amount of asbestos present, therefore UKAS accreditation does not permit quantification.
6. If, during fibre identification, only 1 or 2 fibres are seen and identified as asbestos, then the term 'trace asbestos identified' is used.
7. This report shall not be reproduced except in full, without written approval of Envirochem.

SIGNATURE:

Authorised signatory

PRINT NAME: Stefan Kitchener

**Reg. No. 2378228 England. Registered Office: Envirochem, 12 The Gardens, Broadcut, Fareham, Hampshire, PO16 8SS.**



**ENVIROCHEM**  
**Analytical Laboratories Ltd.**  
12 The Gardens  
Broadcut, Fareham  
Hampshire  
PO16 8SS



Our Ref: J178825 FI: 1  
Your Ref: 3113  
Date: 06/11/2019

Tel: (01329) 287777  
Fax: (01329) 287755  
www.envirochem.co.uk  
office@envirochem.co.uk

## Asbestos Fibre Identification Report

**Client:** Armour Analytical Services Ltd  
Admirals Yard, Station Road, Patchway, Bristol, BS34 6LR

**Site Address:** 31 The Mall, Kennet Centre Market Place, Newbury, RG14 5EN

**Sampled By:** Armour Analytical Services Ltd

**Date sampled/received:** 5th November 2019

**Date analysed:** 6th November 2019

**Analyst/s:** Stefan Kitchener

**Analysis Location:** 12 The Gardens, Broadcut, Fareham, Hampshire, PO16 8SS

### ANALYTICAL PROCEDURE

Fibre identification was carried out in accordance with the documented 'in-house' method (2.01) based on the HSE Guidance Note HSG 248. These employed stereo microscopy, polarized microscopy and dispersion staining techniques.

### RESULTS

Sample No.	Sample Ref.	Location	Asbestos Detected	Asbestos Type
NE/1	BS584564	First Floor 001 Store - Vinyl floor tiles	Yes	Chrysotile

NOTES:

1. Sample(s) were examined for the presence of 6 types of asbestos fibres: crocidolite (blue), amosite (brown), chrysotile (white), anthophyllite, actinolite and tremolite.
2. The results shown in this test report specifically refer to the sample(s) tested as received unless otherwise stated and samples collected by the client are evaluated using information provided by the client. For samples collected by the client the date of receipt is deemed to be the same as the date sampled.
3. Envirochem is a UKAS accredited laboratory for sampling and identification of asbestos containing materials.
4. Comments, observations and opinions are outside the scope of UKAS accreditation.
5. The analytical method in the HSG248 does not quantify the amount of asbestos present, therefore UKAS accreditation does not permit quantification.
6. If, during fibre identification, only 1 or 2 fibres are seen and identified as asbestos, then the term 'trace asbestos identified' is used.
7. This report shall not be reproduced except in full, without written approval of Envirochem.

SIGNATURE:

Authorised signatory

PRINT NAME: Stefan Kitchener

**Reg. No. 2378228 England. Registered Office: Envirochem, 12 The Gardens, Broadcut, Fareham, Hampshire, PO16 8SS.**





**ENVIROCHEM**  
**Analytical Laboratories Ltd.**  
12 The Gardens  
Broadcut, Fareham  
Hampshire  
PO16 8SS



Our Ref: J178800 FI: 2  
Your Ref: 3113  
Date: 06/11/2019

Tel: (01329) 287777  
Fax: (01329) 287755  
www.envirochem.co.uk  
office@envirochem.co.uk

## Asbestos Fibre Identification Report

**Client:** Armour Analytical Services Ltd  
Admirals Yard, Station Road, Patchway, Bristol, BS34 6LR

**Site Address:** 34 The Mall, Kennet Centre Market Place, Newbury, RG14 5EN

**Sampled By:** Armour Analytical Services Ltd

**Date sampled/received:** 5th November 2019

**Date analysed:** 6th November 2019

**Analyst/s:** Stefan Kitchener

**Analysis Location:** 12 The Gardens, Broadcut, Fareham, Hampshire, PO16 8SS

### ANALYTICAL PROCEDURE

Fibre identification was carried out in accordance with the documented 'in-house' method (2.01) based on the HSE Guidance Note HSG 248. These employed stereo microscopy, polarized microscopy and dispersion staining techniques.

### RESULTS

Sample No.	Sample Ref.	Location	Asbestos Detected	Asbestos Type
1	BS584486	First Floor WC - Vinyl floor tiles	No	
2	BS584487	First Floor Kitchen - Vinyl floor tiles	No	

#### NOTES:

1. Sample(s) were examined for the presence of 6 types of asbestos fibres: crocidolite (blue), amosite (brown), chrysotile (white), anthophyllite, actinolite and tremolite.
2. The results shown in this test report specifically refer to the sample(s) tested as received unless otherwise stated and samples collected by the client are evaluated using information provided by the client. For samples collected by the client the date of receipt is deemed to be the same as the date sampled.
3. Envirochem is a UKAS accredited laboratory for sampling and identification of asbestos containing materials.
4. Comments, observations and opinions are outside the scope of UKAS accreditation.
5. The analytical method in the HSG248 does not quantify the amount of asbestos present, therefore UKAS accreditation does not permit quantification.
6. If, during fibre identification, only 1 or 2 fibres are seen and identified as asbestos, then the term 'trace asbestos identified' is used.
7. This report shall not be reproduced except in full, without written approval of Envirochem.

SIGNATURE:

Authorised signatory

PRINT NAME: Stefan Kitchener

**Reg. No. 2378228 England. Registered Office: Envirochem, 12 The Gardens, Broadcut, Fareham, Hampshire, PO16 8SS.**



**ENVIROCHEM**  
**Analytical Laboratories Ltd.**  
12 The Gardens  
Broadcut, Fareham  
Hampshire  
PO16 8SS



Our Ref: J178795 FI: 3  
Your Ref: 3113  
Date: 06/11/2019

Tel: (01329) 287777  
Fax: (01329) 287755  
www.envirochem.co.uk  
office@envirochem.co.uk

## Asbestos Fibre Identification Report

**Client:** Armour Analytical Services Ltd  
Admirals Yard, Station Road, Patchway, Bristol, BS34 6LR

**Site Address:** 36 The Mall, Kennet Centre Market Place, Newbury, RG14 5EN

**Sampled By:** Armour Analytical Services Ltd

**Date sampled/received:** 5th November 2019

**Date analysed:** 6th November 2019

**Analyst/s:** Stefan Kitchener

**Analysis Location:** 12 The Gardens, Broadcut, Fareham, Hampshire, PO16 8SS

### ANALYTICAL PROCEDURE

Fibre identification was carried out in accordance with the documented 'in-house' method (2.01) based on the HSE Guidance Note HSG 248. These employed stereo microscopy, polarized microscopy and dispersion staining techniques.

### RESULTS

Sample No.	Sample Ref.	Location	Asbestos Detected	Asbestos Type
NE/1	BS584469	First Floor Store - Vinyl floor tiles	No	
NE/2	BS584470	First Floor Kitchen - Vinyl floor tiles	No	
NE/3	BS584471	Ground Floor Cupboard - Vinyl floor tiles	No	

#### NOTES:

1. Sample(s) were examined for the presence of 6 types of asbestos fibres: crocidolite (blue), amosite (brown), chrysotile (white), anthophyllite, actinolite and tremolite.
2. The results shown in this test report specifically refer to the sample(s) tested as received unless otherwise stated and samples collected by the client are evaluated using information provided by the client. For samples collected by the client the date of receipt is deemed to be the same as the date sampled.
3. Envirochem is a UKAS accredited laboratory for sampling and identification of asbestos containing materials.
4. Comments, observations and opinions are outside the scope of UKAS accreditation.
5. The analytical method in the HSG248 does not quantify the amount of asbestos present, therefore UKAS accreditation does not permit quantification.
6. If, during fibre identification, only 1 or 2 fibres are seen and identified as asbestos, then the term 'trace asbestos identified' is used.
7. This report shall not be reproduced except in full, without written approval of Envirochem.

SIGNATURE:

Authorised signatory

PRINT NAME: Stefan Kitchener

**Reg. No. 2378228 England. Registered Office: Envirochem, 12 The Gardens, Broadcut, Fareham, Hampshire, PO16 8SS.**



**ENVIROCHEM**  
**Analytical Laboratories Ltd.**  
12 The Gardens  
Broadcut, Fareham  
Hampshire  
PO16 8SS



Our Ref: J178805 FI: 1  
Your Ref: 3113  
Date: 06/11/2019

Tel: (01329) 287777  
Fax: (01329) 287755  
www.envirochem.co.uk  
office@envirochem.co.uk

## Asbestos Fibre Identification Report

**Client:** Armour Analytical Services Ltd  
Admirals Yard, Station Road, Patchway, Bristol, BS34 6LR

**Site Address:** 38A The Mall, Kennet Centre Market Place, Newbury, RG14 5EN

**Sampled By:** Armour Analytical Services Ltd

**Date sampled/received:** 5th November 2019

**Date analysed:** 6th November 2019

**Analyst/s:** Stefan Kitchener

**Analysis Location:** 12 The Gardens, Broadcut, Fareham, Hampshire, PO16 8SS

### ANALYTICAL PROCEDURE

Fibre identification was carried out in accordance with the documented 'in-house' method (2.01) based on the HSE Guidance Note HSG 248. These employed stereo microscopy, polarized microscopy and dispersion staining techniques.

### RESULTS

Sample No.	Sample Ref.	Location	Asbestos Detected	Asbestos Type
NE/1	BS584495	Ground Floor, Shop Floor - Vinyl floor tiles	No	

NOTES:

1. Sample(s) were examined for the presence of 6 types of asbestos fibres: crocidolite (blue), amosite (brown), chrysotile (white), anthophyllite, actinolite and tremolite.
2. The results shown in this test report specifically refer to the sample(s) tested as received unless otherwise stated and samples collected by the client are evaluated using information provided by the client. For samples collected by the client the date of receipt is deemed to be the same as the date sampled.
3. Envirochem is a UKAS accredited laboratory for sampling and identification of asbestos containing materials.
4. Comments, observations and opinions are outside the scope of UKAS accreditation.
5. The analytical method in the HSG248 does not quantify the amount of asbestos present, therefore UKAS accreditation does not permit quantification.
6. If, during fibre identification, only 1 or 2 fibres are seen and identified as asbestos, then the term 'trace asbestos identified' is used.
7. This report shall not be reproduced except in full, without written approval of Envirochem.

SIGNATURE:

Authorised signatory

PRINT NAME: Stefan Kitchener

**Reg. No. 2378228 England. Registered Office: Envirochem, 12 The Gardens, Broadcut, Fareham, Hampshire, PO16 8SS.**



**ENVIROCHEM**  
**Analytical Laboratories Ltd.**  
12 The Gardens  
Broadcut, Fareham  
Hampshire  
PO16 8SS



Our Ref: J178824 FI: 2  
Your Ref: 3113  
Date: 06/11/2019

Tel: (01329) 287777  
Fax: (01329) 287755  
www.envirochem.co.uk  
office@envirochem.co.uk

## Asbestos Fibre Identification Report

**Client:** Armour Analytical Services Ltd  
Admirals Yard, Station Road, Patchway, Bristol, BS34 6LR

**Site Address:** 143-145 Bartholomew Street, .

**Sampled By:** Armour Analytical Services Ltd

**Date sampled/received:** 5th November 2019

**Date analysed:** 6th November 2019

**Analyst/s:** Stefan Kitchener

**Analysis Location:** 12 The Gardens, Broadcut, Fareham, Hampshire, PO16 8SS

### ANALYTICAL PROCEDURE

Fibre identification was carried out in accordance with the documented 'in-house' method (2.01) based on the HSE Guidance Note HSG 248. These employed stereo microscopy, polarized microscopy and dispersion staining techniques.

### RESULTS

Sample No.	Sample Ref.	Location	Asbestos Detected	Asbestos Type
NE/1	BS584562	First Floor 003 WC - Vinyl floor tiles	No	
NE/2	BS584563	First Floor 005 Kitchen - Sink pad	Yes	Chrysotile

#### NOTES:

1. Sample(s) were examined for the presence of 6 types of asbestos fibres: crocidolite (blue), amosite (brown), chrysotile (white), anthophyllite, actinolite and tremolite.
2. The results shown in this test report specifically refer to the sample(s) tested as received unless otherwise stated and samples collected by the client are evaluated using information provided by the client. For samples collected by the client the date of receipt is deemed to be the same as the date sampled.
3. Envirochem is a UKAS accredited laboratory for sampling and identification of asbestos containing materials.
4. Comments, observations and opinions are outside the scope of UKAS accreditation.
5. The analytical method in the HSG248 does not quantify the amount of asbestos present, therefore UKAS accreditation does not permit quantification.
6. If, during fibre identification, only 1 or 2 fibres are seen and identified as asbestos, then the term 'trace asbestos identified' is used.
7. This report shall not be reproduced except in full, without written approval of Envirochem.

SIGNATURE:

Authorised signatory

PRINT NAME: Stefan Kitchener

**Reg. No. 2378228 England. Registered Office: Envirochem, 12 The Gardens, Broadcut, Fareham, Hampshire, PO16 8SS.**



**ENVIROCHEM**  
**Analytical Laboratories Ltd.**  
12 The Gardens  
Broadcut, Fareham  
Hampshire  
PO16 8SS



Our Ref: J178830 FI: 3  
Your Ref: 3113  
Date: 06/11/2019

Tel: (01329) 287777  
Fax: (01329) 287755  
www.envirochem.co.uk  
office@envirochem.co.uk

## Asbestos Fibre Identification Report

**Client:** Armour Analytical Services Ltd  
Admirals Yard, Station Road, Patchway, Bristol, BS34 6LR

**Site Address:** Kennet Centre Market Place, Newbury, .

**Sampled By:** Armour Analytical Services Ltd

**Date sampled/received:** 5th November 2019

**Date analysed:** 6th November 2019

**Analyst/s:** Stefan Kitchener

**Analysis Location:** 12 The Gardens, Broadcut, Fareham, Hampshire, PO16 8SS

### ANALYTICAL PROCEDURE

Fibre identification was carried out in accordance with the documented 'in-house' method (2.01) based on the HSE Guidance Note HSG 248. These employed stereo microscopy, polarized microscopy and dispersion staining techniques.

### RESULTS

Sample No.	Sample Ref.	Location	Asbestos Detected	Asbestos Type
NE/1	BS584568	First Floor 001 Store - Vinyl floor tiles	Yes	Chrysotile
NE/2	BS584569	First Floor 003 WC - Toilet cistern	Yes	Amosite
NE/3	BS584570	Ground Floor 001 Shop Floor - Vinyl floor tiles	Yes	Chrysotile

NOTES:

1. Sample(s) were examined for the presence of 6 types of asbestos fibres: crocidolite (blue), amosite (brown), chrysotile (white), anthophyllite, actinolite and tremolite.
2. The results shown in this test report specifically refer to the sample(s) tested as received unless otherwise stated and samples collected by the client are evaluated using information provided by the client. For samples collected by the client the date of receipt is deemed to be the same as the date sampled.
3. Envirochem is a UKAS accredited laboratory for sampling and identification of asbestos containing materials.
4. Comments, observations and opinions are outside the scope of UKAS accreditation.
5. The analytical method in the HSG248 does not quantify the amount of asbestos present, therefore UKAS accreditation does not permit quantification.
6. If, during fibre identification, only 1 or 2 fibres are seen and identified as asbestos, then the term 'trace asbestos identified' is used.
7. This report shall not be reproduced except in full, without written approval of Envirochem.

SIGNATURE:

Authorised signatory

PRINT NAME: Stefan Kitchener

**Reg. No. 2378228 England. Registered Office: Envirochem, 12 The Gardens, Broadcut, Fareham, Hampshire, PO16 8SS.**